

**2024 ROADWAY EVALUATION SURVEY**

**TOWN OF RIVER BEND  
CRAVEN COUNTY, NORTH CAROLINA**

**Prepared for:**

**Town of River Bend  
45 Shoreline Drive  
New Bern, NC 28562**

**Prepared by:**

**Avolis Engineering, PA  
P.O. Box 15564  
New Bern, NC 28561  
(252)633-0068 Office**

**March 18, 2003  
Updated May 16, 2007  
Updated January 29, 2008  
Updated July 22, 2024**



*The Town's 2024 Roadway Evaluation Survey is a tool used by the Town Council for short-range and long-range planning for future paving and maintenance of the town's streets. The document is based on a snapshot of street conditions as of July, 2024. This document will likely have a lifespan of 10+ years. During that time, street conditions, and subsequently street paving/maintenance priorities, are subject to change.*

*Each year, during the budget process, the Town Council uses engineering recommendations and budget data to make a final decision on funding for street projects. While the Council uses the paving recommendations contained in this document as a guide to establish a priority ranking, there is no guarantee that future street paving will exactly follow the priority ranking as contained in this document.*

## **TABLE OF CONTENTS**

<b>1.0</b>	<b>INTRODUCTION AND PURPOSE.....</b>	<b>1</b>
<b>2.0</b>	<b>SURVEY METHODOLOGY.....</b>	<b>2</b>
<b>3.0</b>	<b>INSPECTION RESULTS.....</b>	<b>9</b>
<b>4.0</b>	<b>SUMMARY AND RECOMMENDATIONS.....</b>	<b>10</b>

## **APPENDICES**

- Appendix A**    **Alphabetized Roadway Listing**
- Appendix B**    **Prioritized Roadway Listing**
- Appendix C**    **Roadway Inspection Reports**

## **FIGURES**

- Figure 1**        **2020 Powell Bill Map**
- Figure 2**        **Overall Roadway Map**

## **1.0 INTRODUCTION AND PURPOSE**

The Town of River Bend is responsible for the maintenance and repair of public roads within the Corporate Limits of the Town. It is the Town's desire to utilize its limited resources for roadway maintenance in a responsible manner addressing maintenance and repair needs on a prioritized basis that will result in the best, long-term performance of the roadway system. In order to accomplish this objective, an assessment of roadway conditions and maintenance priorities is needed.

Avolis Engineering, P.A. was contracted by the Town of River Bend to perform an assessment of municipal streets. Private streets were not evaluated. Avolis Engineering, P.A. was tasked with inspecting all public roads, preparing a report documenting maintenance and repair needs and providing a prioritized listing of roadway maintenance and repair needs. This report documents the findings of this roadway assessment.

Avolis Engineering, P.A. prepared the original Roadway Assessment Report in 2003. This report was utilized as a guide and tool in completing roadway repairs and resurfacing from 2003 - 2007. This report was updated to reflect current conditions in 2007. Minor wording edits were made in 2008. The findings contained in this previous report were reviewed at the onset of this inspection effort to help identify those roads that are degrading more rapidly than originally anticipated and to note those repairs that have been previously completed.

This report documents the roadway conditions as of July 2024. The prioritized listing of repairs and maintenance needs was formulated based upon pavement conditions and traffic loading. Cost estimates provided for each priority road segment are based upon current market conditions and are not adjusted for inflation. These figures should be adjusted for inflation if repairs are undertaken in future years.

## **2.0 SURVEY METHODOLOGY**

Avolis Engineering, P.A. utilized the methodology and practices presented in the North Carolina Department of Transportation, Pavement Condition Survey Manual for Raters, dated 2023 as a guide to complete this pavement condition survey. All pavement surfaces and conditions were assessed, based on a visual inspection by Kevin Avolis, P.E. Pavement surfaces were inspected first on foot and secondly by vehicle. The pavement surfaces were assessed for severity of the following pavement failure conditions:

- A. Alligator Cracking
- B. Traverse Cracking
- C. Rutting

- D. Raveling
- E. Bleeding
- F. Ride Quality
- G. Patching

Each pavement failure condition and rating criteria is described in detail below. Photos included for each pavement failure condition were taken from the NCDOT Pavement Condition Survey Manual for Raters, 2023.

### **A. Alligator Cracking**

Alligator cracking is a load associated structural failure. The failure can be either in the surface, base or subbase. Permanent deformation (rutting) does not have to be present for there to be alligator cracking. Cracking first begins in the wheel path, usually as longitudinal cracking. Further stress creates an alligator pattern. If the surface is very flexible, the longitudinal crack will become wider and an alligator pattern may not develop until severe distress sets in. The proper corrective measure for both alligator and longitudinal cracking is the same since a structural failure is taking place in both cases. Alligator cracking also includes cracking along the pavement edge.

Alligator cracking is rated based upon the percentage of pavement area exhibiting cracking at different degrees of severity (i.e. 10% - None, 30% - Light, 60% - Severe).





## B. Transverse Cracking

Block cracks divide the pavement up into roughly rectangular pieces. Block cracking is not load-associated. Cracks are generally caused by shrinkage of the asphalt concrete and daily temperature cycling. Wheel path loads can increase the severity of block cracking if water is allowed to penetrate into the cracks. It is therefore very important to seal these cracks to prevent water penetration into the base materials.

Traverse cracks are rated as light, moderate, or severe as follows:

- (L)ight:** Cracks, usually only transverse, are less than ¼-inch wide and are not spalled: block pattern may not be visible yet; transverse cracks usually 10 to 20 feet apart. Cracks have little or no spalling and joints are usually not bumped up.
- (M)oderate:** Block pattern may be visible with blocks 10 square feet or greater present; cracks are ¼-inch and ½-inch wide; cracks may or may not be spalled; transverse cracks usually 5 to 20 feet apart
- (S)evere:** Cracks may be severally spalled with smaller blocks 2 to 10 square feet present; cracks usually greater than ½-inch wide; transverse cracks may be 1 to 2 feet apart throughout portions of the surface.



### C. Rutting

A rut is a surface depression in the wheel path(s) or at the edge of pavement. Rutting comes from a pavement deformation in any of the pavement layers or in the subgrade, usually caused by consolidation or lateral movement of the materials due to traffic loads. Movement in the mix in hot weather or inadequate compaction during construction is the main cause of rutting.

Rutting is rated as light, moderate, or severe as follows:

**(L)ight:** rutting  $\frac{1}{4}$  to less than  $\frac{1}{2}$ -inch deep.

**(M)oderate:** Rutting  $\frac{1}{2}$  to less than 1-inch deep.

**(S)evere:** Rutting 1-inch deep or greater.



## D. Raveling

Raveling is the wearing away of the pavement surface caused by the dislodging of aggregate particles or loss of asphalt binder. Raveling is more common on slurry surfaces than on plant mix surfaces. Raveling indicates either a hardening or poor application of asphalt binder.

Raveling is rated as light, moderate or severe as follows:

- (L)ight:** Aggregate loss is not great; small amounts of stripping may be detected; aggregate has started to wear away.
- (M)oderate:** Some stripping evident, random stripping with small areas (less than one square foot) or strips of aggregate broken away.
- (S)evere:** Stripping very evident; aggregate accumulations may be a problem; large sections (greater than one square foot) of stripping with aggregate layer broken away.





## E. Bleeding

Bleeding is a film of bituminous material on the pavement surface that creates a shiny, reflective surface. Bleeding is caused by excess asphalt cement in the mix and/or low air void content. During hot weather the asphalt fills the voids of the mix and then expands out onto the surface of the pavement.

Bleeding is rated as light, moderate, or severe as follows:

**(L)ight:** Condition is present on 10 to 25 percent of the section.

**(M)oderate:** Condition is present on 26 to 50 percent of the section.

**(S)evere:** Condition is present on greater than 50 percent of the section.



## **F. Ride Quality**

Ride quality is what the general public perceives as the indicator of how well a road is holding up. Edge rutting, patching and localized dips significantly contribute to ride quality. Ride quality is assessed at the posted speed limit.

Ride quality is rated as light, moderate, or severe as follows:

**(L)ight (Average):** Pavement texture may cause minimum tire noise, isolated cases (up to  $\frac{1}{4}$  of the section) of bumps and dips, operating speed can be maintained safely.

**(M)oderate (Slightly Rough):**  $\frac{1}{4}$  to  $\frac{1}{2}$  of the section is uneven and bumpy with dips, rises, and ruts; pavement may be broken and cracked with a resulting increase in tire noise; slight difficulty in maintaining operating speed safely.

**(S)evere (Rough):** Greater than  $\frac{1}{2}$  of section is uneven and bumpy; rider is frequently jostled; rather large and frequent pavement failures and rough texture may be present causing a high increase in tire noise and jolts; operating speed cannot be maintained safely.

## G. Patching

Patching is defined as any surface area of the existing pavement that indicates some type of maintenance repair has taken place. These patched areas may be skin patches, edges, overlays or full depth patches. They may be in spot locations, along one or both edges, in the wheel paths, across the entire surface for short distances, or a combination of any of these. The quality and condition of the patch is not considered in evaluating patching. It does not matter if all the patches are alligator cracked, rutted or potholed. These conditions are measured in the other distresses. Patching is an indication of the amount of surface area that has received some type of maintenance repair that may or may not be holding up.



To document pavement areas, measurements were taken with hand tapes and measuring wheels. Where appropriate, area calculations were completed by computer based measurements.

Pavement striping was assessed through a visual inspection to determine general striping conditions, unnecessary striping, misplaced striping, and striping deficiencies.

Measurements were made to document each road's width and length. These measurements were utilized to quantify the efforts needed to repair and resurface each road segment.

The information observed for each road segment is documented on the Individual Road Condition Survey forms included in Appendix C.

### 3.0 INSPECTION RESULTS

Each of the Town's public road segments was inspected utilizing the procedure outlined in **Section 2.0** above. Upon the completion of this inspection effort, a review was made of the documented roadway conditions.

The overall conditions of the road system within the Town of River Bend is considered to be relatively good. Based upon the repair and overlay efforts that have been completed within the last 24 years, it is apparent that the Town of River Bend actively pursues and addresses the repair and maintenance needs of its road system to ensure its long-term performance.

The anticipated serviceable life of asphalt roadways is 20 to 30 years and is dependent upon the integrity of the roadway section and the traffic loading. A large portion of the Town's roadways have been overlaid over the last 24 years. Those roadway segments that have not been overlaid and are the originally constructed pavement sections exhibited the highest level of degradation. Additionally, those roadway segments that were overlaid in excess of 18 – 20 years ago as a part of the Town's maintenance program are beginning to exhibit light to moderate signs of pavement distress.

A prioritized listing of repair and maintenance needs was formulated based upon the factors outlined above. Twelve roadway segments were identified as priorities requiring maintenance and repair needs over the next 3 to 5 year period.

Included in Appendix **A** is an alphabetized listing of all roadway segments evaluated. Included in Appendix **B** is a priority ranking of road segments based on repair and maintenance needs. This priority listing was formulated considering all of the factors discussed in **Section 2.0** above. Those roads needing the most immediate attention are identified by a higher priority number (Priority 1, 2, 3...).

**Figure 1** includes the Town of River Bend Powell Bill Map and documents the roadway sections inspected. Included in **Figure 2** is an Overall Roadway Map. This map visually depicts roadway repairs completed in 2000 through 2024.

#### 4.0 SUMMARY AND RECOMMENDATIONS

The prioritized listing of roadway maintenance and repair needs provides the recommended sequence of repair and maintenance efforts as of July 2024. The following road segments were identified that are of original construction and have not received an overlay in the Town’s Maintenance Program:

PRIORITY	ROAD SEGMENT	PROJECT COST
1	Norbury Drive	\$124,000.00
2	Margo Court	\$11,500.00
3	Marina Road	\$32,100.00
4	Wakefield Drive	\$41,750.00
5	Pilot Place	\$11,500.00
6	Lantern Lane	\$7,700.00
7	Quarterdeck Cluster I and II	\$84,000.00
8	Pier Pointe	\$105,100.00
9	Bluff Court	\$12,800.00
<b>Total Cost – Priority 1 - 9</b>		<b>\$430,450.00</b>

These roadway segments should be programmed for resurfacing as funding becomes available.

Other roadway segments identified that will require maintenance and repair needs within the next 3 to 5 years include the following:

PRIORITY	ROAD SEGMENT	PROJECT COST
10	Pirates Road – Shoreline Drive to Wakefield Drive	\$267,000.00
11	Shoreline Drive – US Highway 17 to Plantation Drive South	\$454,900.00
12	Plantation Drive – Gull Pointe to Shoreline Drive South	\$230,325.00
<b>Total Cost – Priority 10 - 11</b>		<b>\$952,225.00</b>

These roadway segments are classified as thoroughfare roads and are subject to heavier traffic loading than the roadway segments identified as Priority 1 – 9 (all local roads). These thoroughfare road segments should be monitored annually as the maintenance program for that year is developed to ensure that all critical maintenance needs are addressed and that these thoroughfare segments are not allowed to deteriorate to a state that would require significant repairs.



# Appendix A



ALPHABETIC LISTING OF ROADWAYS - TOWN OF RIVER BEND

ROAD NAME	PRIORITY NUMBER	TRAFFIC LOADING THOROUGHFARE / COLLECTOR / LOCAL	ESTIMATED COST OF REPAIRS/OVERLAY	OVERALL RIDE QUALITY			OVERALL ROAD CONDITIONS		
				GOOD	FAIR	POOR	GOOD	FAIR	POOR
ANCHOR WAY - NORTH		LOCAL							
ANCHOR WAY - SOUTH		LOCAL							
BARBARA DRIVE		LOCAL							
BAYSWATER COURT		LOCAL							
BAYWOOD COURT		LOCAL							
BLUFF COURT	9	LOCAL	\$12,800.00						
BOATSWAIN DRIVE		LOCAL							
BOWLINE ROAD		COLLECTOR							
BRENTWOOD COURT		LOCAL							
CANEBRAKE DRIVE		COLLECTOR							
CAPTAINS COVE		LOCAL							
CARRIAGE HOUSE COURT		LOCAL							
CHANNEL RUN DRIVE		THOROUGHFARE							
CLIPPER COURT		LOCAL							
COMMANDER CIRCLE		LOCAL							
COMPASS COURT		LOCAL							
COURTNEY LANE		LOCAL							
EFIRD BOULEVARD		LOCAL							
ESQUIRE COURT		LOCAL							
GANGPLANK LOOP ROAD TO RIGHT		LOCAL							
GANGPLANK ROAD		LOCAL							
GATEWOOD DRIVE - PINWOOD TO TAR LANDING		COLLECTOR							
GATEWOOD DRIVE - PLANTATION DRIVE TO PINWOOD DRIVE		COLLECTOR							
GATEWOOD DRIVE - TAR LANDING TO WEST END		COLLECTOR							
GENTRY COVE		LOCAL							
GULL POINTE		LOCAL							
GULL POINTE EXTENSION		LOCAL							
KETCH COURT		LOCAL							
KNOLLWOOD COURT		LOCAL							
KNOTLINE		LOCAL							
LAKEMERE DRIVE		COLLECTOR							
LANTERN LANE	6	LOCAL	\$7,700.00						
LAUREN COURT		LOCAL							
LOCHBRIDGE		COLLECTOR							
MARGO COURT	2	LOCAL	\$11,500.00						
MARINA ROAD	3	LOCAL	\$32,100.00						
MARINERS COURT		LOCAL							
MASSACHUSETTS ROAD		LOCAL							
MASTER COURT		LOCAL							
MULBERRY LANE (EAST/WEST)		LOCAL							
MULBERRY LANE (NORTH/SOUTH)		LOCAL							
NAUTICAL DRIVE		LOCAL							
NEW HAMPSHIRE LANE		LOCAL							
NORBURY DRIVE	1	LOCAL	\$124,000.00						
NORTH CAROLINA DRIVE		LOCAL							
OAKLEAF COURT		LOCAL							
O'HARA DRIVE		LOCAL							
OLD POLLOCKSVILLE ROAD		LOCAL							
OUTRIGGER ROAD		LOCAL							
PARKWOOD COURT		LOCAL							
PIER POINTE	8	LOCAL	\$105,100.00						
PILLORY CIRCLE		LOCAL							
PILOT PLACE	5	LOCAL	\$11,500.00						
PINEWOOD DRIVE		COLLECTOR							
PIRATES ROAD - SHORELINE DRIVE TO WAKEFIELD DRIVE	10	THOROUGHFARE	\$267,000.00						
PIRATES ROAD - WAKEFIELD DRIVE TO HIGHWAY 17		THOROUGHFARE							
PLANTATION DRIVE - GULL POINTE TO SHORELINE (SOUTH)	12	THOROUGHFARE	\$230,325.00						
PLANTATION DRIVE - PINWOOD DRIVE TO WEST END		COLLECTOR							
PLANTATION DRIVE - SHORELINE DRIVE TO PINWOOD DRIVE		THOROUGHFARE							
PLANTATION DRIVE - SHORELINE NORTH TO GULL POINTE		THOROUGHFARE							
PORTSIDE LANE		LOCAL							
QUARTERDECK - CLUSTER I and II	7	LOCAL	\$84,000.00						
QUARTERDECK ROAD CLUSTER III		LOCAL							
RAFT ROAD		LOCAL							
RANDOMWOOD LANE		COLLECTOR							
ROCKLEDGE ROAD		THOROUGHFARE							
SAILORS COURT		LOCAL							
SANDPIPER COURT		LOCAL							
SEAFARERS COURT		LOCAL							
SEXTANT COURT		LOCAL							
SHORELINE DRIVE - INTERSECTION 17 TO PLANTATION SOUTH	11	THOROUGHFARE	\$454,900.00						
SHORELINE DRIVE - REMAINING SEGMENTS (PLANTATION SOUTH TO ROCKLEDGE)		COLLECTOR							
STARBOARD DRIVE		LOCAL							
STILLWATER COURT		LOCAL							
TAR LANDING		LOCAL							
TEAKWOOD DRIVE		COLLECTOR							
VIRGINIA COURT		LOCAL							
VIRGINIA COURT EXTENSION		LOCAL							
WAKEFIELD DRIVE	4	LOCAL	\$41,750.00						
WESTCHESTER		COLLECTOR							
WILDWOOD DRIVE		COLLECTOR							
WILLOWBROOK		LOCAL							



# Appendix B



PRIORITY RANKING OF ROADWAY SEGMENTS - TOWN OF RIVER BEND

ROAD NAME	PRIORITY NUMBER	TRAFFIC LOADING	ESTIMATED COST OF REPAIRS/OVERLAY	OVERALL RIDE QUALITY			OVERALL ROAD CONDITIONS		
		THOROUGHFARE / COLLECTOR / LOCAL		GOOD	FAIR	POOR	GOOD	FAIR	POOR
NORBURY DRIVE	1	LOCAL	\$124,000.00						
MARGO COURT	2	LOCAL	\$11,500.00						
MARINA ROAD	3	LOCAL	\$32,100.00						
WAKEFIELD DRIVE	4	LOCAL	\$41,750.00						
PILOT PLACE	5	LOCAL	\$11,500.00						
LANTERN LANE	6	LOCAL	\$7,700.00						
QUARTERDECK - CLUSTER I and II	7	LOCAL	\$84,000.00						
PIER POINTE	8	LOCAL	\$105,100.00						
BLUFF COURT	9	LOCAL	\$12,800.00						
PIRATES ROAD - SHORELINE DRIVE TO WAKEFIELD DRIVE	10	THOROUGHFARE	\$267,000.00						
SHORELINE DRIVE - INTERSECTION 17 TO PLANTATION SOUTH	11	THOROUGHFARE	\$454,900.00						
PLANTATION DRIVE - GULL POINTE TO SHORELINE (SOUTH)	12	THOROUGHFARE	\$230,325.00						
ANCHOR WAY - NORTH		LOCAL							
ANCHOR WAY - SOUTH		LOCAL							
BRENTWOOD COURT		LOCAL							
COMPASS COURT		LOCAL							
GATEWOOD DRIVE - TAR LANDING TO WEST END		COLLECTOR							
GENTRY COVE		LOCAL							
KETCH COURT		LOCAL							
KNOTLINE		LOCAL							
LAUREN COURT		LOCAL							
MARINERS COURT		LOCAL							
MASTER COURT		LOCAL							
NEW HAMPSHIRE LANE		LOCAL							
OAKLEAF COURT		LOCAL							
OLD POLLOCKSVILLE ROAD		LOCAL							
PIRATES ROAD - WAKEFIELD DRIVE TO HIGHWAY 17		THOROUGHFARE							
RANDOMWOOD LANE		COLLECTOR							
ROCKLEDGE ROAD		THOROUGHFARE							
SANDPIPER COURT		LOCAL							
SHORELINE DRIVE - REMAINING SEGMENTS (PLANTATION SOUTH TO ROCKLEDGE)		COLLECTOR							
VIRGINIA COURT		LOCAL							
BARBARA DRIVE		LOCAL							
BAYSWATER COURT		LOCAL							
BAYWOOD COURT		LOCAL							
BOATSWAIN DRIVE		LOCAL							
BOWLINE ROAD		COLLECTOR							
CANEBRAKE DRIVE		COLLECTOR							
CAPTAINS COVE		LOCAL							
CARRIAGE HOUSE COURT		LOCAL							
CHANNEL RUN DRIVE		THOROUGHFARE							
CLIPPER COURT		LOCAL							
COMMANDER CIRCLE		LOCAL							
COURTNEY LANE		LOCAL							
EFIRD BOULEVARD		LOCAL							
ESQUIRE COURT		LOCAL							
GANGPLANK LOOP ROAD TO RIGHT		LOCAL							
GANGPLANK ROAD		LOCAL							
GATEWOOD DRIVE - PINWOOD TO TAR LANDING		COLLECTOR							
GATEWOOD DRIVE - PLANTATION DRIVE TO PINWOOD DRIVE		COLLECTOR							
GULL POINTE		LOCAL							
GULL POINTE EXTENSION		LOCAL							
KNOLLWOOD COURT		LOCAL							
LAKEMERE DRIVE		COLLECTOR							
LOCHBRIDGE		COLLECTOR							
MASSACHUSETTS ROAD		LOCAL							
MULBERRY LANE (EAST/WEST)		LOCAL							
MULBERRY LANE (NORTH/SOUTH)		LOCAL							
NAUTICAL DRIVE		LOCAL							
NORTH CAROLINA DRIVE		LOCAL							
O'HARA DRIVE		LOCAL							
OUTRIGGER ROAD		LOCAL							
PARKWOOD COURT		LOCAL							
PILLORY CIRCLE		LOCAL							
PINEWOOD DRIVE		COLLECTOR							
PLANTATION DRIVE - PINWOOD DRIVE TO WEST END		COLLECTOR							
PLANTATION DRIVE - SHORELINE DRIVE TO PINWOOD DRIVE		THOROUGHFARE							
PLANTATION DRIVE - SHORELINE NORTH TO GULL POINTE		THOROUGHFARE							
PORTSIDE LANE		LOCAL							
QUARTERDECK ROAD CLUSTER III		LOCAL							
RAFT ROAD		LOCAL							
SAILORS COURT		LOCAL							
SEAFARERS COURT		LOCAL							
SEXTANT COURT		LOCAL							
STARBOARD DRIVE		LOCAL							
STILLWATER COURT		LOCAL							
TAR LANDING		LOCAL							
TEAKWOOD DRIVE		COLLECTOR							
VIRGINIA COURT EXTENSION		LOCAL							
WESTCHESTER		COLLECTOR							
WILDWOOD DRIVE		COLLECTOR							
WILLOWBROOK		LOCAL							



# Appendix C

## 2024 ROADWAY INSPECTION REPORT TOWN OF RIVER BEND, NORTH CAROLINA

**ROAD NAME** ANCHOR WAY - NORTH  
**TRAFFIC LOADING** THOROUGHFARE   
 COLLECTOR   
 LOCAL   
**PRIORITY NUMBER**  
**APPROXIMATE LENGTH** 1,110 LF **AVERAGE WIDTH** 10 LF  
**TOTAL PAVEMENT AREA (SQUARE YARDS)** 1,418 SY  
**PAVEMENT MARKINGS**  **PAVEMENT SECTION** DITCH

### VISUAL INSPECTION SUMMARY

TYPE OF DISTRESS	SEVERITY			
	NONE	LIGHT	MODERATE	SEVERE
ALLIGATOR CRACKING	<input type="checkbox"/>	<input checked="" type="checkbox"/>	<input type="checkbox"/>	<input type="checkbox"/>
BLOCK/TRANSVERSE CRACKING	<input type="checkbox"/>	<input type="checkbox"/>	<input checked="" type="checkbox"/>	<input type="checkbox"/>
RUTTING	<input checked="" type="checkbox"/>	<input type="checkbox"/>	<input type="checkbox"/>	<input type="checkbox"/>
RAVELING	<input checked="" type="checkbox"/>	<input type="checkbox"/>	<input type="checkbox"/>	<input type="checkbox"/>
BLEEDING	<input checked="" type="checkbox"/>	<input type="checkbox"/>	<input type="checkbox"/>	<input type="checkbox"/>
EXISTING PATCHING	<input type="checkbox"/>	<input checked="" type="checkbox"/>	<input type="checkbox"/>	<input type="checkbox"/>
OVERALL RIDE QUALITY	GOOD <input type="checkbox"/>	FAIR <input checked="" type="checkbox"/>	POOR <input type="checkbox"/>	
OVERALL ROAD CONDITION	GOOD <input type="checkbox"/>	FAIR <input checked="" type="checkbox"/>	POOR <input type="checkbox"/>	

**COMMENTS:**

This road segment was resurfaced as a part of the 2000 Paving Program.

## 2024 ROADWAY INSPECTION REPORT TOWN OF RIVER BEND, NORTH CAROLINA

**ROAD NAME** ANCHOR WAY – SOUTH  
**TRAFFIC LOADING** THOROUGHFARE   
 COLLECTOR   
 LOCAL   
**PRIORITY NUMBER**  
**APPROXIMATE LENGTH** 1,110 LF **AVERAGE WIDTH** 10 LF  
**TOTAL PAVEMENT AREA (SQUARE YARDS)** 1,418 SY  
**PAVEMENT MARKINGS**  **PAVEMENT SECTION** DITCH

### VISUAL INSPECTION SUMMARY

TYPE OF DISTRESS	SEVERITY			
	NONE	LIGHT	MODERATE	SEVERE
ALLIGATOR CRACKING	<input type="checkbox"/>	<input checked="" type="checkbox"/>	<input type="checkbox"/>	<input type="checkbox"/>
BLOCK/TRANSVERSE CRACKING	<input type="checkbox"/>	<input checked="" type="checkbox"/>	<input type="checkbox"/>	<input type="checkbox"/>
RUTTING	<input checked="" type="checkbox"/>	<input type="checkbox"/>	<input type="checkbox"/>	<input type="checkbox"/>
RAVELING	<input checked="" type="checkbox"/>	<input type="checkbox"/>	<input type="checkbox"/>	<input type="checkbox"/>
BLEEDING	<input checked="" type="checkbox"/>	<input type="checkbox"/>	<input type="checkbox"/>	<input type="checkbox"/>
EXISTING PATCHING	<input type="checkbox"/>	<input checked="" type="checkbox"/>	<input type="checkbox"/>	<input type="checkbox"/>
OVERALL RIDE QUALITY	GOOD <input type="checkbox"/>	FAIR <input checked="" type="checkbox"/>	POOR <input type="checkbox"/>	
OVERALL ROAD CONDITION	GOOD <input type="checkbox"/>	FAIR <input checked="" type="checkbox"/>	POOR <input type="checkbox"/>	

**COMMENTS:**

This road segment was resurfaced as a part of the 2011 Paving Program.

## 2024 ROADWAY INSPECTION REPORT TOWN OF RIVER BEND, NORTH CAROLINA

<b>ROAD NAME</b>	BARBARA DRIVE		
		<b>TRAFFIC LOADING</b>	THOROUGHFARE <input type="checkbox"/> COLLECTOR <input type="checkbox"/> LOCAL <input checked="" type="checkbox"/>
<b>PRIORITY NUMBER</b>			
<b>APPROXIMATE LENGTH</b>	1,640 LF	<b>AVERAGE WIDTH</b>	18 LF
<b>TOTAL PAVEMENT AREA (SQUARE YARDS)</b>	3,722 SY		
<b>PAVEMENT MARKINGS</b>	<input checked="" type="checkbox"/>	<b>PAVEMENT SECTION</b>	DITCH

### VISUAL INSPECTION SUMMARY

TYPE OF DISTRESS	SEVERITY			
	NONE	LIGHT	MODERATE	SEVERE
ALLIGATOR CRACKING	<input checked="" type="checkbox"/>	<input type="checkbox"/>	<input type="checkbox"/>	<input type="checkbox"/>
BLOCK/TRANSVERSE CRACKING	<input checked="" type="checkbox"/>	<input type="checkbox"/>	<input type="checkbox"/>	<input type="checkbox"/>
RUTTING	<input checked="" type="checkbox"/>	<input type="checkbox"/>	<input type="checkbox"/>	<input type="checkbox"/>
RAVELING	<input checked="" type="checkbox"/>	<input type="checkbox"/>	<input type="checkbox"/>	<input type="checkbox"/>
BLEEDING	<input checked="" type="checkbox"/>	<input type="checkbox"/>	<input type="checkbox"/>	<input type="checkbox"/>
EXISTING PATCHING	<input checked="" type="checkbox"/>	<input type="checkbox"/>	<input type="checkbox"/>	<input type="checkbox"/>
OVERALL RIDE QUALITY	GOOD <input checked="" type="checkbox"/>	FAIR <input type="checkbox"/>	POOR <input type="checkbox"/>	
OVERALL ROAD CONDITION	GOOD <input checked="" type="checkbox"/>	FAIR <input type="checkbox"/>	POOR <input type="checkbox"/>	

**COMMENTS:**

This road segment was resurfaced as a part of the 2013 Paving Program.



## 2024 ROADWAY INSPECTION REPORT TOWN OF RIVER BEND, NORTH CAROLINA

<b>ROAD NAME</b>	BAYSWATER COURT		
		<b>TRAFFIC LOADING</b>	THOROUGHFARE <input type="checkbox"/> COLLECTOR <input type="checkbox"/> LOCAL <input checked="" type="checkbox"/>
<b>PRIORITY NUMBER</b>			
<b>APPROXIMATE LENGTH</b>	640 LF	<b>AVERAGE WIDTH</b>	22 LF
<b>TOTAL PAVEMENT AREA (SQUARE YARDS)</b>	1,800 SY		
<b>PAVEMENT MARKINGS</b>	<input type="checkbox"/>	<b>PAVEMENT SECTION</b>	CURB & GUTTER

### VISUAL INSPECTION SUMMARY

TYPE OF DISTRESS	SEVERITY			
	NONE	LIGHT	MODERATE	SEVERE
ALLIGATOR CRACKING	<input type="checkbox"/>	<input checked="" type="checkbox"/>	<input type="checkbox"/>	<input type="checkbox"/>
BLOCK/TRANSVERSE CRACKING	<input type="checkbox"/>	<input checked="" type="checkbox"/>	<input type="checkbox"/>	<input type="checkbox"/>
RUTTING	<input checked="" type="checkbox"/>	<input type="checkbox"/>	<input type="checkbox"/>	<input type="checkbox"/>
RAVELING	<input checked="" type="checkbox"/>	<input type="checkbox"/>	<input type="checkbox"/>	<input type="checkbox"/>
BLEEDING	<input checked="" type="checkbox"/>	<input type="checkbox"/>	<input type="checkbox"/>	<input type="checkbox"/>
EXISTING PATCHING	<input checked="" type="checkbox"/>	<input type="checkbox"/>	<input type="checkbox"/>	<input type="checkbox"/>
OVERALL RIDE QUALITY	GOOD <input type="checkbox"/>	FAIR <input checked="" type="checkbox"/>	POOR <input type="checkbox"/>	
OVERALL ROAD CONDITION	GOOD <input checked="" type="checkbox"/>	FAIR <input type="checkbox"/>	POOR <input type="checkbox"/>	

**COMMENTS:**

This road segment was resurfaced as a part of the 2015 Paving Program.

# 2024 ROADWAY INSPECTION REPORT

## TOWN OF RIVER BEND, NORTH CAROLINA

**ROAD NAME**                      BAYWOOD COURT

**TRAFFIC LOADING**

THOROUGHFARE	<input type="checkbox"/>
COLLECTOR	<input type="checkbox"/>
LOCAL	<input checked="" type="checkbox"/>

**PRIORITY NUMBER**

**APPROXIMATE LENGTH**    LF                                      **AVERAGE WIDTH**                      LF

**TOTAL PAVEMENT AREA (SQUARE YARDS)**    SY

**PAVEMENT MARKINGS**                                          **PAVEMENT SECTION**                      DITCH

### VISUAL INSPECTION SUMMARY

TYPE OF DISTRESS	SEVERITY			
	NONE	LIGHT	MODERATE	SEVERE
ALLIGATOR CRACKING	<input type="checkbox"/>	<input checked="" type="checkbox"/>	<input type="checkbox"/>	<input type="checkbox"/>
BLOCK/TRANSVERSE CRACKING	<input type="checkbox"/>	<input checked="" type="checkbox"/>	<input type="checkbox"/>	<input type="checkbox"/>
RUTTING	<input checked="" type="checkbox"/>	<input type="checkbox"/>	<input type="checkbox"/>	<input type="checkbox"/>
RAVELING	<input checked="" type="checkbox"/>	<input type="checkbox"/>	<input type="checkbox"/>	<input type="checkbox"/>
BLEEDING	<input checked="" type="checkbox"/>	<input type="checkbox"/>	<input type="checkbox"/>	<input type="checkbox"/>
EXISTING PATCHING	<input checked="" type="checkbox"/>	<input type="checkbox"/>	<input type="checkbox"/>	<input type="checkbox"/>
OVERALL RIDE QUALITY	GOOD <input checked="" type="checkbox"/>	FAIR <input type="checkbox"/>	POOR <input type="checkbox"/>	
OVERALL ROAD CONDITION	GOOD <input checked="" type="checkbox"/>	FAIR <input type="checkbox"/>	POOR <input type="checkbox"/>	

**COMMENTS:**

This road segment was resurfaced as a part of the 2006 Paving Program.

# 2024 ROADWAY INSPECTION REPORT

## TOWN OF RIVER BEND, NORTH CAROLINA

**ROAD NAME**                      BLUFF COURT

**TRAFFIC LOADING**

THOROUGHFARE	<input type="checkbox"/>
COLLECTOR	<input type="checkbox"/>
LOCAL	<input checked="" type="checkbox"/>

**PRIORITY NUMBER**

**APPROXIMATE LENGTH**    160 LF

**AVERAGE WIDTH**            20 LF

**TOTAL PAVEMENT AREA (SQUARE YARDS)**    409 SY

**PAVEMENT MARKINGS**   

**PAVEMENT SECTION**        CURB & GUTTER

### VISUAL INSPECTION SUMMARY

TYPE OF DISTRESS	SEVERITY			
	NONE	LIGHT	MODERATE	SEVERE
ALLIGATOR CRACKING	<input type="checkbox"/>	<input type="checkbox"/>	<input type="checkbox"/>	<input checked="" type="checkbox"/>
BLOCK/TRANSVERSE CRACKING	<input type="checkbox"/>	<input checked="" type="checkbox"/>	<input type="checkbox"/>	<input type="checkbox"/>
RUTTING	<input checked="" type="checkbox"/>	<input type="checkbox"/>	<input type="checkbox"/>	<input type="checkbox"/>
RAVELING	<input checked="" type="checkbox"/>	<input type="checkbox"/>	<input type="checkbox"/>	<input type="checkbox"/>
BLEEDING	<input checked="" type="checkbox"/>	<input type="checkbox"/>	<input type="checkbox"/>	<input type="checkbox"/>
EXISTING PATCHING	<input type="checkbox"/>	<input checked="" type="checkbox"/>	<input type="checkbox"/>	<input type="checkbox"/>
 OVERALL RIDE QUALITY	GOOD <input type="checkbox"/>	FAIR <input checked="" type="checkbox"/>	POOR <input type="checkbox"/>	
OVERALL ROAD CONDITION	GOOD <input type="checkbox"/>	FAIR <input type="checkbox"/>	POOR <input checked="" type="checkbox"/>	

**COMMENTS:**

This roadway segment has not been resurfaced. Roadway construction appears to be original.

## 2024 ROADWAY INSPECTION REPORT TOWN OF RIVER BEND, NORTH CAROLINA

<b>ROAD NAME</b>	BOATSWAIN DRIVE		
		<b>TRAFFIC LOADING</b>	THOROUGHFARE <input type="checkbox"/> COLLECTOR <input type="checkbox"/> LOCAL <input checked="" type="checkbox"/>
<b>PRIORITY NUMBER</b>			
<b>APPROXIMATE LENGTH</b>	480 LF	<b>AVERAGE WIDTH</b>	18 LF
<b>TOTAL PAVEMENT AREA (SQUARE YARDS)</b>	1,100 SY		
<b>PAVEMENT MARKINGS</b>	<input type="checkbox"/>	<b>PAVEMENT SECTION</b>	DITCH

### VISUAL INSPECTION SUMMARY

TYPE OF DISTRESS	SEVERITY			
	NONE	LIGHT	MODERATE	SEVERE
ALLIGATOR CRACKING	<input type="checkbox"/>	<input checked="" type="checkbox"/>	<input type="checkbox"/>	<input type="checkbox"/>
BLOCK/TRANSVERSE CRACKING	<input type="checkbox"/>	<input checked="" type="checkbox"/>	<input type="checkbox"/>	<input type="checkbox"/>
RUTTING	<input checked="" type="checkbox"/>	<input type="checkbox"/>	<input type="checkbox"/>	<input type="checkbox"/>
RAVELING	<input type="checkbox"/>	<input checked="" type="checkbox"/>	<input type="checkbox"/>	<input type="checkbox"/>
BLEEDING	<input checked="" type="checkbox"/>	<input type="checkbox"/>	<input type="checkbox"/>	<input type="checkbox"/>
EXISTING PATCHING	<input type="checkbox"/>	<input checked="" type="checkbox"/>	<input type="checkbox"/>	<input type="checkbox"/>
OVERALL RIDE QUALITY	GOOD <input checked="" type="checkbox"/>	FAIR <input type="checkbox"/>	POOR <input type="checkbox"/>	
OVERALL ROAD CONDITION	GOOD <input checked="" type="checkbox"/>	FAIR <input type="checkbox"/>	POOR <input type="checkbox"/>	

**COMMENTS:**

This road segment was resurfaced as a part of the 2015 Paving Program.

## 2024 ROADWAY INSPECTION REPORT TOWN OF RIVER BEND, NORTH CAROLINA

<b>ROAD NAME</b>	BOWLINE ROAD		
		<b>TRAFFIC LOADING</b>	THOROUGHFARE <input type="checkbox"/> COLLECTOR <input checked="" type="checkbox"/> LOCAL <input type="checkbox"/>
<b>PRIORITY NUMBER</b>			
<b>APPROXIMATE LENGTH</b>	530 LF	<b>AVERAGE WIDTH</b>	18 LF
<b>TOTAL PAVEMENT AREA (SQUARE YARDS)</b>	1,219 SY		
<b>PAVEMENT MARKINGS</b>	<input type="checkbox"/>	<b>PAVEMENT SECTION</b>	DITCH

### VISUAL INSPECTION SUMMARY

TYPE OF DISTRESS	SEVERITY			
	NONE	LIGHT	MODERATE	SEVERE
ALLIGATOR CRACKING	<input type="checkbox"/>	<input checked="" type="checkbox"/>	<input type="checkbox"/>	<input type="checkbox"/>
BLOCK/TRANSVERSE CRACKING	<input type="checkbox"/>	<input checked="" type="checkbox"/>	<input type="checkbox"/>	<input type="checkbox"/>
RUTTING	<input checked="" type="checkbox"/>	<input type="checkbox"/>	<input type="checkbox"/>	<input type="checkbox"/>
RAVELING	<input checked="" type="checkbox"/>	<input type="checkbox"/>	<input type="checkbox"/>	<input type="checkbox"/>
BLEEDING	<input checked="" type="checkbox"/>	<input type="checkbox"/>	<input type="checkbox"/>	<input type="checkbox"/>
EXISTING PATCHING	<input type="checkbox"/>	<input checked="" type="checkbox"/>	<input type="checkbox"/>	<input type="checkbox"/>
OVERALL RIDE QUALITY	GOOD <input checked="" type="checkbox"/>	FAIR <input type="checkbox"/>	POOR <input type="checkbox"/>	
OVERALL ROAD CONDITION	GOOD <input checked="" type="checkbox"/>	FAIR <input type="checkbox"/>	POOR <input type="checkbox"/>	

**COMMENTS:**

This road segment was resurfaced as a part of the 2012 Paving Program.

## 2024 ROADWAY INSPECTION REPORT TOWN OF RIVER BEND, NORTH CAROLINA

**ROAD NAME** BRENTWOOD COURT

**TRAFFIC LOADING**  
 THOROUGHFARE   
 COLLECTOR   
 LOCAL

**PRIORITY NUMBER**

**APPROXIMATE LENGTH** 317 LF

**AVERAGE WIDTH** 18 LF

**TOTAL PAVEMENT AREA (SQUARE YARDS)** 729 SY

**PAVEMENT MARKINGS**

**PAVEMENT SECTION** DITCH

### VISUAL INSPECTION SUMMARY

TYPE OF DISTRESS	SEVERITY			
	NONE	LIGHT	MODERATE	SEVERE
ALLIGATOR CRACKING	<input type="checkbox"/>	<input checked="" type="checkbox"/>	<input type="checkbox"/>	<input type="checkbox"/>
BLOCK/TRANSVERSE CRACKING	<input type="checkbox"/>	<input type="checkbox"/>	<input checked="" type="checkbox"/>	<input type="checkbox"/>
RUTTING	<input type="checkbox"/>	<input checked="" type="checkbox"/>	<input type="checkbox"/>	<input type="checkbox"/>
RAVELING	<input type="checkbox"/>	<input checked="" type="checkbox"/>	<input type="checkbox"/>	<input type="checkbox"/>
BLEEDING	<input type="checkbox"/>	<input checked="" type="checkbox"/>	<input type="checkbox"/>	<input type="checkbox"/>
EXISTING PATCHING	<input type="checkbox"/>	<input checked="" type="checkbox"/>	<input type="checkbox"/>	<input type="checkbox"/>
OVERALL RIDE QUALITY	GOOD <input checked="" type="checkbox"/>	FAIR <input type="checkbox"/>	POOR <input type="checkbox"/>	
OVERALL ROAD CONDITION	GOOD <input type="checkbox"/>	FAIR <input checked="" type="checkbox"/>	POOR <input type="checkbox"/>	

**COMMENTS:**

This road segment was resurfaced as a part of the 2002 Paving Program.

## 2024 ROADWAY INSPECTION REPORT TOWN OF RIVER BEND, NORTH CAROLINA

**ROAD NAME**                      CANEBRAKE DRIVE

	THOROUGHFARE <input type="checkbox"/>
<b>TRAFFIC LOADING</b>	COLLECTOR <input checked="" type="checkbox"/>
	LOCAL <input type="checkbox"/>

**PRIORITY NUMBER**

<b>APPROXIMATE LENGTH</b> 690 LF	<b>AVERAGE WIDTH</b> 18 LF
----------------------------------	----------------------------

**TOTAL PAVEMENT AREA (SQUARE YARDS)**    2,028 SY

<b>PAVEMENT MARKINGS</b> <input type="checkbox"/>	<b>PAVEMENT SECTION</b> DITCH
---	-------------------------------

### VISUAL INSPECTION SUMMARY

TYPE OF DISTRESS	SEVERITY			
	NONE	LIGHT	MODERATE	SEVERE
ALLIGATOR CRACKING	■	<input type="checkbox"/>	<input type="checkbox"/>	<input type="checkbox"/>
BLOCK/TRANSVERSE CRACKING	<input type="checkbox"/>	■	<input type="checkbox"/>	<input type="checkbox"/>
RUTTING	■	<input type="checkbox"/>	<input type="checkbox"/>	<input type="checkbox"/>
RAVELING	<input type="checkbox"/>	■	<input type="checkbox"/>	<input type="checkbox"/>
BLEEDING	■	<input type="checkbox"/>	<input type="checkbox"/>	<input type="checkbox"/>
EXISTING PATCHING	■	<input type="checkbox"/>	<input type="checkbox"/>	<input type="checkbox"/>
 OVERALL RIDE QUALITY	GOOD   ■	FAIR <input type="checkbox"/>	POOR <input type="checkbox"/>	
OVERALL ROAD CONDITION	GOOD   ■	FAIR <input type="checkbox"/>	POOR <input type="checkbox"/>	

**COMMENTS:**

This road segment was resurfaced as a part of the 2018 Paving Program.

## 2024 ROADWAY INSPECTION REPORT TOWN OF RIVER BEND, NORTH CAROLINA

**ROAD NAME** CAPTAINS COVE

**TRAFFIC LOADING**  
 THOROUGHFARE   
 COLLECTOR   
 LOCAL

**PRIORITY NUMBER**

**APPROXIMATE LENGTH** 160 LF

**AVERAGE WIDTH** 18 LF

**TOTAL PAVEMENT AREA (SQUARE YARDS)** 368 SY

**PAVEMENT MARKINGS**

**PAVEMENT SECTION** DITCH

### VISUAL INSPECTION SUMMARY

TYPE OF DISTRESS	SEVERITY			
	NONE	LIGHT	MODERATE	SEVERE
ALLIGATOR CRACKING	<input type="checkbox"/>	<input checked="" type="checkbox"/>	<input type="checkbox"/>	<input type="checkbox"/>
BLOCK/TRANSVERSE CRACKING	<input type="checkbox"/>	<input checked="" type="checkbox"/>	<input type="checkbox"/>	<input type="checkbox"/>
RUTTING	<input checked="" type="checkbox"/>	<input type="checkbox"/>	<input type="checkbox"/>	<input type="checkbox"/>
RAVELING	<input checked="" type="checkbox"/>	<input type="checkbox"/>	<input type="checkbox"/>	<input type="checkbox"/>
BLEEDING	<input checked="" type="checkbox"/>	<input type="checkbox"/>	<input type="checkbox"/>	<input type="checkbox"/>
EXISTING PATCHING	<input checked="" type="checkbox"/>	<input type="checkbox"/>	<input type="checkbox"/>	<input type="checkbox"/>
OVERALL RIDE QUALITY	GOOD <input checked="" type="checkbox"/>	FAIR <input type="checkbox"/>	POOR <input type="checkbox"/>	
OVERALL ROAD CONDITION	GOOD <input checked="" type="checkbox"/>	FAIR <input type="checkbox"/>	POOR <input type="checkbox"/>	

**COMMENTS:**

This road segment was resurfaced as a part of the 2015 Paving Program.



# 2024 ROADWAY INSPECTION REPORT

## TOWN OF RIVER BEND, NORTH CAROLINA

**ROAD NAME**                      CARRAIGE HOUSE COURT

**TRAFFIC LOADING**

THOROUGHFARE	<input type="checkbox"/>
COLLECTOR	<input type="checkbox"/>
LOCAL	<input checked="" type="checkbox"/>

**PRIORITY NUMBER**

**APPROXIMATE LENGTH**    383 LF                                      **AVERAGE WIDTH**                      18 LF

**TOTAL PAVEMENT AREA (SQUARE YARDS)**    861 SY

**PAVEMENT MARKINGS**                                          **PAVEMENT SECTION**                      SHOULDER

### VISUAL INSPECTION SUMMARY

TYPE OF DISTRESS	SEVERITY			
	NONE	LIGHT	MODERATE	SEVERE
ALLIGATOR CRACKING	■	<input type="checkbox"/>	<input type="checkbox"/>	<input type="checkbox"/>
BLOCK/TRANSVERSE CRACKING	■	<input type="checkbox"/>	<input type="checkbox"/>	<input type="checkbox"/>
RUTTING	■	<input type="checkbox"/>	<input type="checkbox"/>	<input type="checkbox"/>
RAVELING	■	<input type="checkbox"/>	<input type="checkbox"/>	<input type="checkbox"/>
BLEEDING	■	<input type="checkbox"/>	<input type="checkbox"/>	<input type="checkbox"/>
EXISTING PATCHING	■	<input type="checkbox"/>	<input type="checkbox"/>	<input type="checkbox"/>
 OVERALL RIDE QUALITY	GOOD ■	FAIR <input type="checkbox"/>	POOR <input type="checkbox"/>	
OVERALL ROAD CONDITION	GOOD ■	FAIR <input type="checkbox"/>	POOR <input type="checkbox"/>	

**COMMENTS:**

This road segment was resurfaced as a part of the 2018 Paving Program.

## 2024 ROADWAY INSPECTION REPORT TOWN OF RIVER BEND, NORTH CAROLINA

**ROAD NAME** CHANNEL RUN DRIVE

**TRAFFIC LOADING** THOROUGHFARE   
COLLECTOR   
LOCAL

**PRIORITY NUMBER**

**APPROXIMATE LENGTH** 2,590 LF

**AVERAGE WIDTH** 18 LF

**TOTAL PAVEMENT AREA (SQUARE YARDS)** 6,000 SY

**PAVEMENT MARKINGS**

**PAVEMENT SECTION** DITCH

### VISUAL INSPECTION SUMMARY

TYPE OF DISTRESS	SEVERITY			
	NONE	LIGHT	MODERATE	SEVERE
ALLIGATOR CRACKING	<input type="checkbox"/>	<input checked="" type="checkbox"/>	<input type="checkbox"/>	<input type="checkbox"/>
BLOCK/TRANSVERSE CRACKING	<input type="checkbox"/>	<input checked="" type="checkbox"/>	<input type="checkbox"/>	<input type="checkbox"/>
RUTTING	<input type="checkbox"/>	<input checked="" type="checkbox"/>	<input type="checkbox"/>	<input type="checkbox"/>
RAVELING	<input type="checkbox"/>	<input checked="" type="checkbox"/>	<input type="checkbox"/>	<input type="checkbox"/>
BLEEDING	<input checked="" type="checkbox"/>	<input type="checkbox"/>	<input type="checkbox"/>	<input type="checkbox"/>
EXISTING PATCHING	<input type="checkbox"/>	<input checked="" type="checkbox"/>	<input type="checkbox"/>	<input type="checkbox"/>
OVERALL RIDE QUALITY	GOOD <input checked="" type="checkbox"/>	FAIR <input type="checkbox"/>	POOR <input type="checkbox"/>	
OVERALL ROAD CONDITION	GOOD <input checked="" type="checkbox"/>	FAIR <input type="checkbox"/>	POOR <input type="checkbox"/>	

**COMMENTS:**

This road segment was resurfaced as a part of the 2005 Paving Program.





## 2024 ROADWAY INSPECTION REPORT TOWN OF RIVER BEND, NORTH CAROLINA

**ROAD NAME** COMPASS COURT

**TRAFFIC LOADING**  
 THOROUGHFARE   
 COLLECTOR   
 LOCAL

**PRIORITY NUMBER**

**APPROXIMATE LENGTH** 215 LF **AVERAGE WIDTH** 18 LF

**TOTAL PAVEMENT AREA (SQUARE YARDS)** 495 SY

**PAVEMENT MARKINGS**  **PAVEMENT SECTION** DITCH

### VISUAL INSPECTION SUMMARY

TYPE OF DISTRESS	SEVERITY			
	NONE	LIGHT	MODERATE	SEVERE
ALLIGATOR CRACKING	<input type="checkbox"/>	<input checked="" type="checkbox"/>	<input type="checkbox"/>	<input type="checkbox"/>
BLOCK/TRANSVERSE CRACKING	<input type="checkbox"/>	<input type="checkbox"/>	<input checked="" type="checkbox"/>	<input type="checkbox"/>
RUTTING	<input checked="" type="checkbox"/>	<input type="checkbox"/>	<input type="checkbox"/>	<input type="checkbox"/>
RAVELING	<input checked="" type="checkbox"/>	<input type="checkbox"/>	<input type="checkbox"/>	<input type="checkbox"/>
BLEEDING	<input checked="" type="checkbox"/>	<input type="checkbox"/>	<input type="checkbox"/>	<input type="checkbox"/>
EXISTING PATCHING	<input checked="" type="checkbox"/>	<input type="checkbox"/>	<input type="checkbox"/>	<input type="checkbox"/>
OVERALL RIDE QUALITY	GOOD <input type="checkbox"/>	FAIR <input checked="" type="checkbox"/>	POOR <input type="checkbox"/>	
OVERALL ROAD CONDITION	GOOD <input type="checkbox"/>	FAIR <input checked="" type="checkbox"/>	POOR <input type="checkbox"/>	

**COMMENTS:**

This road segment was resurfaced as a part of the 2004 Paving Program.

## 2024 ROADWAY INSPECTION REPORT TOWN OF RIVER BEND, NORTH CAROLINA

**ROAD NAME** COURTNEY LANE

**TRAFFIC LOADING**  
 THOROUGHFARE   
 COLLECTOR   
 LOCAL

**PRIORITY NUMBER**

**APPROXIMATE LENGTH** 320 LF

**AVERAGE WIDTH** 18 LF

**TOTAL PAVEMENT AREA (SQUARE YARDS)** 736 SY

**PAVEMENT MARKINGS**

**PAVEMENT SECTION** INVERTED PAVEMENT

### VISUAL INSPECTION SUMMARY

TYPE OF DISTRESS	SEVERITY			
	NONE	LIGHT	MODERATE	SEVERE
ALLIGATOR CRACKING	<input type="checkbox"/>	<input checked="" type="checkbox"/>	<input type="checkbox"/>	<input type="checkbox"/>
BLOCK/TRANSVERSE CRACKING	<input type="checkbox"/>	<input checked="" type="checkbox"/>	<input type="checkbox"/>	<input type="checkbox"/>
RUTTING	<input checked="" type="checkbox"/>	<input type="checkbox"/>	<input type="checkbox"/>	<input type="checkbox"/>
RAVELING	<input checked="" type="checkbox"/>	<input type="checkbox"/>	<input type="checkbox"/>	<input type="checkbox"/>
BLEEDING	<input checked="" type="checkbox"/>	<input type="checkbox"/>	<input type="checkbox"/>	<input type="checkbox"/>
EXISTING PATCHING	<input type="checkbox"/>	<input checked="" type="checkbox"/>	<input type="checkbox"/>	<input type="checkbox"/>
OVERALL RIDE QUALITY	GOOD <input checked="" type="checkbox"/>	FAIR <input type="checkbox"/>	POOR <input type="checkbox"/>	
OVERALL ROAD CONDITION	GOOD <input checked="" type="checkbox"/>	FAIR <input type="checkbox"/>	POOR <input type="checkbox"/>	

**COMMENTS:**

This roadway segment has not been resurfaced. Roadway construction appears to be original.

## 2024 ROADWAY INSPECTION REPORT TOWN OF RIVER BEND, NORTH CAROLINA

**ROAD NAME** EFIRD BOULEVARD

**TRAFFIC LOADING**  
 THOROUGHFARE   
 COLLECTOR   
 LOCAL

**PRIORITY NUMBER**

**APPROXIMATE LENGTH** 1,240 LF

**AVERAGE WIDTH** 21 LF

**TOTAL PAVEMENT AREA (SQUARE YARDS)** 3,300 SY

**PAVEMENT MARKINGS**

**PAVEMENT SECTION** DITCH

### VISUAL INSPECTION SUMMARY

TYPE OF DISTRESS	SEVERITY			
	NONE	LIGHT	MODERATE	SEVERE
ALLIGATOR CRACKING	<input checked="" type="checkbox"/>	<input type="checkbox"/>	<input type="checkbox"/>	<input type="checkbox"/>
BLOCK/TRANSVERSE CRACKING	<input checked="" type="checkbox"/>	<input type="checkbox"/>	<input type="checkbox"/>	<input type="checkbox"/>
RUTTING	<input checked="" type="checkbox"/>	<input type="checkbox"/>	<input type="checkbox"/>	<input type="checkbox"/>
RAVELING	<input checked="" type="checkbox"/>	<input type="checkbox"/>	<input type="checkbox"/>	<input type="checkbox"/>
BLEEDING	<input checked="" type="checkbox"/>	<input type="checkbox"/>	<input type="checkbox"/>	<input type="checkbox"/>
EXISTING PATCHING	<input checked="" type="checkbox"/>	<input type="checkbox"/>	<input type="checkbox"/>	<input type="checkbox"/>
OVERALL RIDE QUALITY	GOOD <input checked="" type="checkbox"/>	FAIR <input type="checkbox"/>	POOR <input type="checkbox"/>	
OVERALL ROAD CONDITION	GOOD <input checked="" type="checkbox"/>	FAIR <input type="checkbox"/>	POOR <input type="checkbox"/>	

**COMMENTS:**

This road segment was resurfaced as a part of the 2020 Paving Program.

## 2024 ROADWAY INSPECTION REPORT TOWN OF RIVER BEND, NORTH CAROLINA

**ROAD NAME**                      ESQUIRE COURT

**TRAFFIC LOADING**

THOROUGHFARE	<input type="checkbox"/>
COLLECTOR	<input type="checkbox"/>
LOCAL	<input checked="" type="checkbox"/>

**PRIORITY NUMBER**

**APPROXIMATE LENGTH**    352 LF

**AVERAGE WIDTH**                      18 LF

**TOTAL PAVEMENT AREA (SQUARE YARDS)**    810 SY

**PAVEMENT MARKINGS**   

**PAVEMENT SECTION**                      SHOULDER

### VISUAL INSPECTION SUMMARY

TYPE OF DISTRESS	SEVERITY			
	NONE	LIGHT	MODERATE	SEVERE
ALLIGATOR CRACKING	■	<input type="checkbox"/>	<input type="checkbox"/>	<input type="checkbox"/>
BLOCK/TRANSVERSE CRACKING	■	<input type="checkbox"/>	<input type="checkbox"/>	<input type="checkbox"/>
RUTTING	■	<input type="checkbox"/>	<input type="checkbox"/>	<input type="checkbox"/>
RAVELING	■	<input type="checkbox"/>	<input type="checkbox"/>	<input type="checkbox"/>
BLEEDING	■	<input type="checkbox"/>	<input type="checkbox"/>	<input type="checkbox"/>
EXISTING PATCHING	■	<input type="checkbox"/>	<input type="checkbox"/>	<input type="checkbox"/>
 OVERALL RIDE QUALITY	GOOD ■	FAIR <input type="checkbox"/>	POOR <input type="checkbox"/>	
OVERALL ROAD CONDITION	GOOD ■	FAIR <input type="checkbox"/>	POOR <input type="checkbox"/>	

**COMMENTS:**

This road segment was resurfaced as a part of the 2018 Paving Program.



# 2024 ROADWAY INSPECTION REPORT

## TOWN OF RIVER BEND, NORTH CAROLINA

**ROAD NAME**                      GANGPLANK LOOP ROAD TO RIGHT

	THOROUGHFARE <input type="checkbox"/>
<b>TRAFFIC LOADING</b>	COLLECTOR <input type="checkbox"/>
	LOCAL <input checked="" type="checkbox"/>

**PRIORITY NUMBER**

**APPROXIMATE LENGTH**    275 LF                                      **AVERAGE WIDTH**                      18 LF

**TOTAL PAVEMENT AREA (SQUARE YARDS)**    3,174 SY

**PAVEMENT MARKINGS**                                          **PAVEMENT SECTION**                      DITCH

### VISUAL INSPECTION SUMMARY

TYPE OF DISTRESS	SEVERITY			
	NONE	LIGHT	MODERATE	SEVERE
ALLIGATOR CRACKING	<input type="checkbox"/>	<input checked="" type="checkbox"/>	<input type="checkbox"/>	<input type="checkbox"/>
BLOCK/TRANSVERSE CRACKING	<input type="checkbox"/>	<input checked="" type="checkbox"/>	<input type="checkbox"/>	<input type="checkbox"/>
RUTTING	<input checked="" type="checkbox"/>	<input type="checkbox"/>	<input type="checkbox"/>	<input type="checkbox"/>
RAVELING	<input checked="" type="checkbox"/>	<input type="checkbox"/>	<input type="checkbox"/>	<input type="checkbox"/>
BLEEDING	<input checked="" type="checkbox"/>	<input type="checkbox"/>	<input type="checkbox"/>	<input type="checkbox"/>
EXISTING PATCHING	<input checked="" type="checkbox"/>	<input type="checkbox"/>	<input type="checkbox"/>	<input type="checkbox"/>
OVERALL RIDE QUALITY	GOOD <input type="checkbox"/>	FAIR <input checked="" type="checkbox"/>	POOR <input type="checkbox"/>	
OVERALL ROAD CONDITION	GOOD <input checked="" type="checkbox"/>	FAIR <input type="checkbox"/>	POOR <input type="checkbox"/>	

**COMMENTS:**

This road segment was resurfaced as a part of the 2011 Paving Program.

NOTE: Tree roots damaging pavement.

## 2024 ROADWAY INSPECTION REPORT TOWN OF RIVER BEND, NORTH CAROLINA

**ROAD NAME**                      GANGPLANK ROAD

	THOROUGHFARE <input type="checkbox"/>
<b>TRAFFIC LOADING</b>	COLLECTOR <input type="checkbox"/>
	LOCAL <input checked="" type="checkbox"/>

**PRIORITY NUMBER**

<b>APPROXIMATE LENGTH</b> 1,380 LF	<b>AVERAGE WIDTH</b> 18 LF
------------------------------------	----------------------------

**TOTAL PAVEMENT AREA (SQUARE YARDS)**    3,174 SY

<b>PAVEMENT MARKINGS</b> <input type="checkbox"/>	<b>PAVEMENT SECTION</b> DITCH
---	-------------------------------

### VISUAL INSPECTION SUMMARY

TYPE OF DISTRESS	SEVERITY			
	NONE	LIGHT	MODERATE	SEVERE
ALLIGATOR CRACKING	<input type="checkbox"/>	<input checked="" type="checkbox"/>	<input type="checkbox"/>	<input type="checkbox"/>
BLOCK/TRANSVERSE CRACKING	<input type="checkbox"/>	<input checked="" type="checkbox"/>	<input type="checkbox"/>	<input type="checkbox"/>
RUTTING	<input checked="" type="checkbox"/>	<input type="checkbox"/>	<input type="checkbox"/>	<input type="checkbox"/>
RAVELING	<input checked="" type="checkbox"/>	<input type="checkbox"/>	<input type="checkbox"/>	<input type="checkbox"/>
BLEEDING	<input checked="" type="checkbox"/>	<input type="checkbox"/>	<input type="checkbox"/>	<input type="checkbox"/>
EXISTING PATCHING	<input type="checkbox"/>	<input checked="" type="checkbox"/>	<input type="checkbox"/>	<input type="checkbox"/>
OVERALL RIDE QUALITY	GOOD <input checked="" type="checkbox"/>	FAIR <input type="checkbox"/>	POOR <input type="checkbox"/>	
OVERALL ROAD CONDITION	GOOD <input checked="" type="checkbox"/>	FAIR <input type="checkbox"/>	POOR <input type="checkbox"/>	

**COMMENTS:**

This road segment was resurfaced as a part of the 2006 Paving Program.

## 2024 ROADWAY INSPECTION REPORT TOWN OF RIVER BEND, NORTH CAROLINA

**ROAD NAME**                      GATEWOOD DRIVE – PINWOOD TO TAR LANDING

	THOROUGHFARE <input type="checkbox"/>
<b>TRAFFIC LOADING</b>	COLLECTOR <input checked="" type="checkbox"/>
	LOCAL <input type="checkbox"/>

**PRIORITY NUMBER**

<b>APPROXIMATE LENGTH</b> 400 LF	<b>AVERAGE WIDTH</b> 18 LF
----------------------------------	----------------------------

**TOTAL PAVEMENT AREA (SQUARE YARDS)**    3,000 SY

<b>PAVEMENT MARKINGS</b> <input type="checkbox"/>	<b>PAVEMENT SECTION</b> DITCH
---	-------------------------------

### VISUAL INSPECTION SUMMARY

TYPE OF DISTRESS	SEVERITY			
	NONE	LIGHT	MODERATE	SEVERE
ALLIGATOR CRACKING	<input type="checkbox"/>	<input checked="" type="checkbox"/>	<input type="checkbox"/>	<input type="checkbox"/>
BLOCK/TRANSVERSE CRACKING	<input type="checkbox"/>	<input checked="" type="checkbox"/>	<input type="checkbox"/>	<input type="checkbox"/>
RUTTING	<input checked="" type="checkbox"/>	<input type="checkbox"/>	<input type="checkbox"/>	<input type="checkbox"/>
RAVELING	<input checked="" type="checkbox"/>	<input type="checkbox"/>	<input type="checkbox"/>	<input type="checkbox"/>
BLEEDING	<input checked="" type="checkbox"/>	<input type="checkbox"/>	<input type="checkbox"/>	<input type="checkbox"/>
EXISTING PATCHING	<input checked="" type="checkbox"/>	<input type="checkbox"/>	<input type="checkbox"/>	<input type="checkbox"/>
OVERALL RIDE QUALITY	GOOD <input checked="" type="checkbox"/>	FAIR <input type="checkbox"/>	POOR <input type="checkbox"/>	
OVERALL ROAD CONDITION	GOOD <input checked="" type="checkbox"/>	FAIR <input type="checkbox"/>	POOR <input type="checkbox"/>	

**COMMENTS:**

This road segment was resurfaced as a part of t he 2008 Paving Program.

# 2024 ROADWAY INSPECTION REPORT

## TOWN OF RIVER BEND, NORTH CAROLINA

**ROAD NAME**                      GATEWOOD DRIVE – PLANTATION DRIVE TO PINWOOD DRIVE

	THOROUGHFARE <input type="checkbox"/>
<b>TRAFFIC LOADING</b>	COLLECTOR <input checked="" type="checkbox"/>
	LOCAL <input type="checkbox"/>

**PRIORITY NUMBER**

<b>APPROXIMATE LENGTH</b> 3,561 LF	<b>AVERAGE WIDTH</b> 18 LF
------------------------------------	----------------------------

**TOTAL PAVEMENT AREA (SQUARE YARDS)**    5,500 SY

<b>PAVEMENT MARKINGS</b> <input checked="" type="checkbox"/>	<b>PAVEMENT SECTION</b> DITCH
--	-------------------------------

### VISUAL INSPECTION SUMMARY

TYPE OF DISTRESS	SEVERITY			
	NONE	LIGHT	MODERATE	SEVERE
ALLIGATOR CRACKING	<input type="checkbox"/>	<input checked="" type="checkbox"/>	<input type="checkbox"/>	<input type="checkbox"/>
BLOCK/TRANSVERSE CRACKING	<input type="checkbox"/>	<input checked="" type="checkbox"/>	<input type="checkbox"/>	<input type="checkbox"/>
RUTTING	<input checked="" type="checkbox"/>	<input type="checkbox"/>	<input type="checkbox"/>	<input type="checkbox"/>
RAVELING	<input checked="" type="checkbox"/>	<input type="checkbox"/>	<input type="checkbox"/>	<input type="checkbox"/>
BLEEDING	<input checked="" type="checkbox"/>	<input type="checkbox"/>	<input type="checkbox"/>	<input type="checkbox"/>
EXISTING PATCHING	<input checked="" type="checkbox"/>	<input type="checkbox"/>	<input type="checkbox"/>	<input type="checkbox"/>
OVERALL RIDE QUALITY	GOOD <input checked="" type="checkbox"/>	FAIR <input type="checkbox"/>	POOR <input type="checkbox"/>	
OVERALL ROAD CONDITION	GOOD <input checked="" type="checkbox"/>	FAIR <input type="checkbox"/>	POOR <input type="checkbox"/>	

**COMMENTS:**

This road segment was resurfaced as a part of the 2008 Paving Program.

## 2024 ROADWAY INSPECTION REPORT TOWN OF RIVER BEND, NORTH CAROLINA

**ROAD NAME**                      GATEWOOD DRIVE – TAR LANDING TO WEST END

	THOROUGHFARE <input type="checkbox"/>
<b>TRAFFIC LOADING</b>	COLLECTOR <input checked="" type="checkbox"/>
	LOCAL <input type="checkbox"/>

**PRIORITY NUMBER**

<b>APPROXIMATE LENGTH</b> 3,430 LF	<b>AVERAGE WIDTH</b> 18 LF
------------------------------------	----------------------------

**TOTAL PAVEMENT AREA (SQUARE YARDS)**    6,860 SY

<b>PAVEMENT MARKINGS</b> <input type="checkbox"/>	<b>PAVEMENT SECTION</b> DITCH
---	-------------------------------

### VISUAL INSPECTION SUMMARY

TYPE OF DISTRESS	SEVERITY			
	NONE	LIGHT	MODERATE	SEVERE
ALLIGATOR CRACKING	<input type="checkbox"/>	<input type="checkbox"/>	<input checked="" type="checkbox"/>	<input type="checkbox"/>
BLOCK/TRANSVERSE CRACKING	<input type="checkbox"/>	<input checked="" type="checkbox"/>	<input type="checkbox"/>	<input type="checkbox"/>
RUTTING	<input checked="" type="checkbox"/>	<input type="checkbox"/>	<input type="checkbox"/>	<input type="checkbox"/>
RAVELING	<input checked="" type="checkbox"/>	<input type="checkbox"/>	<input type="checkbox"/>	<input type="checkbox"/>
BLEEDING	<input checked="" type="checkbox"/>	<input type="checkbox"/>	<input type="checkbox"/>	<input type="checkbox"/>
EXISTING PATCHING	<input type="checkbox"/>	<input type="checkbox"/>	<input checked="" type="checkbox"/>	<input type="checkbox"/>
 OVERALL RIDE QUALITY	GOOD <input type="checkbox"/>	FAIR <input checked="" type="checkbox"/>	POOR <input type="checkbox"/>	
OVERALL ROAD CONDITION	GOOD <input type="checkbox"/>	FAIR <input checked="" type="checkbox"/>	POOR <input type="checkbox"/>	

**COMMENTS:**

This roadway segment has not been resurfaced. Roadway construction appears to be original.

# 2024 ROADWAY INSPECTION REPORT

## TOWN OF RIVER BEND, NORTH CAROLINA

**ROAD NAME**                      GENTRY COVE

**TRAFFIC LOADING**

THOROUGHFARE	<input type="checkbox"/>
COLLECTOR	<input type="checkbox"/>
LOCAL	<input checked="" type="checkbox"/>

**PRIORITY NUMBER**

**APPROXIMATE LENGTH**    234 LF

**AVERAGE WIDTH**                      18 LF

**TOTAL PAVEMENT AREA (SQUARE YARDS)**    468 SY

**PAVEMENT MARKINGS**   

**PAVEMENT SECTION**                      CURB & GUTTER

### VISUAL INSPECTION SUMMARY

TYPE OF DISTRESS	SEVERITY			
	NONE	LIGHT	MODERATE	SEVERE
ALLIGATOR CRACKING	<input type="checkbox"/>	<input type="checkbox"/>	<input checked="" type="checkbox"/>	<input type="checkbox"/>
BLOCK/TRANSVERSE CRACKING	<input type="checkbox"/>	<input checked="" type="checkbox"/>	<input type="checkbox"/>	<input type="checkbox"/>
RUTTING	<input checked="" type="checkbox"/>	<input type="checkbox"/>	<input type="checkbox"/>	<input type="checkbox"/>
RAVELING	<input type="checkbox"/>	<input checked="" type="checkbox"/>	<input type="checkbox"/>	<input type="checkbox"/>
BLEEDING	<input checked="" type="checkbox"/>	<input type="checkbox"/>	<input type="checkbox"/>	<input type="checkbox"/>
EXISTING PATCHING	<input type="checkbox"/>	<input checked="" type="checkbox"/>	<input type="checkbox"/>	<input type="checkbox"/>
 OVERALL RIDE QUALITY	GOOD <input type="checkbox"/>	FAIR <input checked="" type="checkbox"/>	POOR <input type="checkbox"/>	
OVERALL ROAD CONDITION	GOOD <input type="checkbox"/>	FAIR <input checked="" type="checkbox"/>	POOR <input type="checkbox"/>	

**COMMENTS:**

This road segment was resurfaced as a part of the 2002 Paving Program.

# 2024 ROADWAY INSPECTION REPORT

## TOWN OF RIVER BEND, NORTH CAROLINA

**ROAD NAME**                      GULL POINTE EXTENSION

**TRAFFIC LOADING**

THOROUGHFARE	<input type="checkbox"/>
COLLECTOR	<input type="checkbox"/>
LOCAL	<input checked="" type="checkbox"/>

**PRIORITY NUMBER**

**APPROXIMATE LENGTH**    LF                                      **AVERAGE WIDTH**                      LF

**TOTAL PAVEMENT AREA (SQUARE YARDS)**    SY

**PAVEMENT MARKINGS**                                          **PAVEMENT SECTION**                      DITCH

### VISUAL INSPECTION SUMMARY

TYPE OF DISTRESS	SEVERITY			
	NONE	LIGHT	MODERATE	SEVERE
ALLIGATOR CRACKING	■	<input type="checkbox"/>	<input type="checkbox"/>	<input type="checkbox"/>
BLOCK/TRANSVERSE CRACKING	■	<input type="checkbox"/>	<input type="checkbox"/>	<input type="checkbox"/>
RUTTING	■	<input type="checkbox"/>	<input type="checkbox"/>	<input type="checkbox"/>
RAVELING	■	<input type="checkbox"/>	<input type="checkbox"/>	<input type="checkbox"/>
BLEEDING	■	<input type="checkbox"/>	<input type="checkbox"/>	<input type="checkbox"/>
EXISTING PATCHING	■	<input type="checkbox"/>	<input type="checkbox"/>	<input type="checkbox"/>
OVERALL RIDE QUALITY	GOOD ■	FAIR <input type="checkbox"/>	POOR <input type="checkbox"/>	
OVERALL ROAD CONDITION	GOOD ■	FAIR <input type="checkbox"/>	POOR <input type="checkbox"/>	

**COMMENTS:**

This roadway segment has not been resurfaced. Roadway construction appears to be original.

## 2024 ROADWAY INSPECTION REPORT TOWN OF RIVER BEND, NORTH CAROLINA

**ROAD NAME**                      GULL POINTE

**TRAFFIC LOADING**

THOROUGHFARE	<input type="checkbox"/>
COLLECTOR	<input type="checkbox"/>
LOCAL	<input checked="" type="checkbox"/>

**PRIORITY NUMBER**

**APPROXIMATE LENGTH**    640 LF

**AVERAGE WIDTH**                      18 LF

**TOTAL PAVEMENT AREA (SQUARE YARDS)**    1,472 SY

**PAVEMENT MARKINGS**   

**PAVEMENT SECTION**                      DITCH

### VISUAL INSPECTION SUMMARY

TYPE OF DISTRESS	SEVERITY			
	NONE	LIGHT	MODERATE	SEVERE
ALLIGATOR CRACKING	<input type="checkbox"/>	<input checked="" type="checkbox"/>	<input type="checkbox"/>	<input type="checkbox"/>
BLOCK/TRANSVERSE CRACKING	<input type="checkbox"/>	<input checked="" type="checkbox"/>	<input type="checkbox"/>	<input type="checkbox"/>
RUTTING	<input checked="" type="checkbox"/>	<input type="checkbox"/>	<input type="checkbox"/>	<input type="checkbox"/>
RAVELING	<input checked="" type="checkbox"/>	<input type="checkbox"/>	<input type="checkbox"/>	<input type="checkbox"/>
BLEEDING	<input checked="" type="checkbox"/>	<input type="checkbox"/>	<input type="checkbox"/>	<input type="checkbox"/>
EXISTING PATCHING	<input type="checkbox"/>	<input checked="" type="checkbox"/>	<input type="checkbox"/>	<input type="checkbox"/>
OVERALL RIDE QUALITY	GOOD <input checked="" type="checkbox"/>	FAIR <input type="checkbox"/>	POOR <input type="checkbox"/>	
OVERALL ROAD CONDITION	GOOD <input checked="" type="checkbox"/>	FAIR <input type="checkbox"/>	POOR <input type="checkbox"/>	

**COMMENTS:**

This roadway segment has not been resurfaced. Roadway construction appears to be original.



## 2024 ROADWAY INSPECTION REPORT TOWN OF RIVER BEND, NORTH CAROLINA

**ROAD NAME**                      KETCH COURT

**TRAFFIC LOADING**

THOROUGHFARE	<input type="checkbox"/>
COLLECTOR	<input type="checkbox"/>
LOCAL	<input checked="" type="checkbox"/>

**PRIORITY NUMBER**

**APPROXIMATE LENGTH**    370 LF

**AVERAGE WIDTH**                      18 LF

**TOTAL PAVEMENT AREA (SQUARE YARDS)**    851 SY

**PAVEMENT MARKINGS**   

**PAVEMENT SECTION**                      DITCH

### VISUAL INSPECTION SUMMARY

TYPE OF DISTRESS	SEVERITY			
	NONE	LIGHT	MODERATE	SEVERE
ALLIGATOR CRACKING	<input type="checkbox"/>	<input checked="" type="checkbox"/>	<input type="checkbox"/>	<input type="checkbox"/>
BLOCK/TRANSVERSE CRACKING	<input type="checkbox"/>	<input type="checkbox"/>	<input checked="" type="checkbox"/>	<input type="checkbox"/>
RUTTING	<input checked="" type="checkbox"/>	<input type="checkbox"/>	<input type="checkbox"/>	<input type="checkbox"/>
RAVELING	<input checked="" type="checkbox"/>	<input type="checkbox"/>	<input type="checkbox"/>	<input type="checkbox"/>
BLEEDING	<input checked="" type="checkbox"/>	<input type="checkbox"/>	<input type="checkbox"/>	<input type="checkbox"/>
EXISTING PATCHING	<input checked="" type="checkbox"/>	<input type="checkbox"/>	<input type="checkbox"/>	<input type="checkbox"/>
 OVERALL RIDE QUALITY	GOOD <input type="checkbox"/>	FAIR <input checked="" type="checkbox"/>	POOR <input type="checkbox"/>	
OVERALL ROAD CONDITION	GOOD <input type="checkbox"/>	FAIR <input checked="" type="checkbox"/>	POOR <input type="checkbox"/>	

**COMMENTS:**

This road segment was resurfaced as a part of the 2002 Paving Program.

## 2024 ROADWAY INSPECTION REPORT TOWN OF RIVER BEND, NORTH CAROLINA

**ROAD NAME**                      KNOLLWOOD COURT

	THOROUGHFARE <input type="checkbox"/>
<b>TRAFFIC LOADING</b>	COLLECTOR <input type="checkbox"/>
	LOCAL <input checked="" type="checkbox"/>

**PRIORITY NUMBER**

**APPROXIMATE LENGTH**    740 LF

**AVERAGE WIDTH**            18 LF

**TOTAL PAVEMENT AREA (SQUARE YARDS)**    1,702 SY

**PAVEMENT MARKINGS**   

**PAVEMENT SECTION**        DITCH

### VISUAL INSPECTION SUMMARY

TYPE OF DISTRESS	SEVERITY			
	NONE	LIGHT	MODERATE	SEVERE
ALLIGATOR CRACKING	<input type="checkbox"/>	<input checked="" type="checkbox"/>	<input type="checkbox"/>	<input type="checkbox"/>
BLOCK/TRANSVERSE CRACKING	<input type="checkbox"/>	<input type="checkbox"/>	<input checked="" type="checkbox"/>	<input type="checkbox"/>
RUTTING	<input checked="" type="checkbox"/>	<input type="checkbox"/>	<input type="checkbox"/>	<input type="checkbox"/>
RAVELING	<input checked="" type="checkbox"/>	<input type="checkbox"/>	<input type="checkbox"/>	<input type="checkbox"/>
BLEEDING	<input checked="" type="checkbox"/>	<input type="checkbox"/>	<input type="checkbox"/>	<input type="checkbox"/>
EXISTING PATCHING	<input type="checkbox"/>	<input checked="" type="checkbox"/>	<input type="checkbox"/>	<input type="checkbox"/>
OVERALL RIDE QUALITY	GOOD <input checked="" type="checkbox"/>	FAIR <input type="checkbox"/>	POOR <input type="checkbox"/>	
OVERALL ROAD CONDITION	GOOD <input checked="" type="checkbox"/>	FAIR <input type="checkbox"/>	POOR <input type="checkbox"/>	

**COMMENTS:**

This road segment was resurfaced as a part of the 2011 Paving Program.

## 2024 ROADWAY INSPECTION REPORT TOWN OF RIVER BEND, NORTH CAROLINA

<b>ROAD NAME</b>	KNOTLINE		
		<b>TRAFFIC LOADING</b>	THOROUGHFARE <input type="checkbox"/>
			COLLECTOR <input type="checkbox"/>
			LOCAL <input checked="" type="checkbox"/>
<b>PRIORITY NUMBER</b>			
<b>APPROXIMATE LENGTH</b>	264 LF	<b>AVERAGE WIDTH</b>	18 LF
<b>TOTAL PAVEMENT AREA (SQUARE YARDS)</b>	607 SY		
<b>PAVEMENT MARKINGS</b>	<input type="checkbox"/>	<b>PAVEMENT SECTION</b>	DITCH

### VISUAL INSPECTION SUMMARY

TYPE OF DISTRESS	SEVERITY			
	NONE	LIGHT	MODERATE	SEVERE
ALLIGATOR CRACKING	<input type="checkbox"/>	<input type="checkbox"/>	<input checked="" type="checkbox"/>	<input type="checkbox"/>
BLOCK/TRANSVERSE CRACKING	<input type="checkbox"/>	<input checked="" type="checkbox"/>	<input type="checkbox"/>	<input type="checkbox"/>
RUTTING	<input checked="" type="checkbox"/>	<input type="checkbox"/>	<input type="checkbox"/>	<input type="checkbox"/>
RAVELING	<input checked="" type="checkbox"/>	<input type="checkbox"/>	<input type="checkbox"/>	<input type="checkbox"/>
BLEEDING	<input checked="" type="checkbox"/>	<input type="checkbox"/>	<input type="checkbox"/>	<input type="checkbox"/>
EXISTING PATCHING	<input type="checkbox"/>	<input checked="" type="checkbox"/>	<input type="checkbox"/>	<input type="checkbox"/>
<b>OVERALL RIDE QUALITY</b>	GOOD <input type="checkbox"/>	FAIR <input checked="" type="checkbox"/>	POOR <input type="checkbox"/>	
<b>OVERALL ROAD CONDITION</b>	GOOD <input type="checkbox"/>	FAIR <input checked="" type="checkbox"/>	POOR <input type="checkbox"/>	

**COMMENTS:**

This road segment was resurfaced as a part of the 2000 Paving Program.

## 2024 ROADWAY INSPECTION REPORT TOWN OF RIVER BEND, NORTH CAROLINA

**ROAD NAME**                      LAKEMERE DRIVE

	THOROUGHFARE <input type="checkbox"/>
<b>TRAFFIC LOADING</b>	COLLECTOR <input checked="" type="checkbox"/>
	LOCAL <input type="checkbox"/>

**PRIORITY NUMBER**

<b>APPROXIMATE LENGTH</b> 2,376 LF	<b>AVERAGE WIDTH</b> 18 LF
------------------------------------	----------------------------

**TOTAL PAVEMENT AREA (SQUARE YARDS)**    5,465 SY

<b>PAVEMENT MARKINGS</b> <input type="checkbox"/>	<b>PAVEMENT SECTION</b> INVERTED PAVEMENT
---	---

### VISUAL INSPECTION SUMMARY

TYPE OF DISTRESS	SEVERITY			
	NONE	LIGHT	MODERATE	SEVERE
ALLIGATOR CRACKING	<input type="checkbox"/>	<input checked="" type="checkbox"/>	<input type="checkbox"/>	<input type="checkbox"/>
BLOCK/TRANSVERSE CRACKING	<input type="checkbox"/>	<input checked="" type="checkbox"/>	<input type="checkbox"/>	<input type="checkbox"/>
RUTTING	<input checked="" type="checkbox"/>	<input type="checkbox"/>	<input type="checkbox"/>	<input type="checkbox"/>
RAVELING	<input checked="" type="checkbox"/>	<input type="checkbox"/>	<input type="checkbox"/>	<input type="checkbox"/>
BLEEDING	<input checked="" type="checkbox"/>	<input type="checkbox"/>	<input type="checkbox"/>	<input type="checkbox"/>
EXISTING PATCHING	<input checked="" type="checkbox"/>	<input type="checkbox"/>	<input type="checkbox"/>	<input type="checkbox"/>
OVERALL RIDE QUALITY	GOOD <input checked="" type="checkbox"/>	FAIR <input type="checkbox"/>	POOR <input type="checkbox"/>	
OVERALL ROAD CONDITION	GOOD <input checked="" type="checkbox"/>	FAIR <input type="checkbox"/>	POOR <input type="checkbox"/>	

**COMMENTS:**

This road segment was resurfaced as a part of the 2020 Paving Program.

## 2024 ROADWAY INSPECTION REPORT TOWN OF RIVER BEND, NORTH CAROLINA

**ROAD NAME**                      LANTERN LANE

**TRAFFIC LOADING**

THOROUGHFARE	<input type="checkbox"/>
COLLECTOR	<input type="checkbox"/>
LOCAL	<input checked="" type="checkbox"/>

**PRIORITY NUMBER**

**APPROXIMATE LENGTH**    106 LF

**AVERAGE WIDTH**                      18 LF

**TOTAL PAVEMENT AREA (SQUARE YARDS)**    244 SY

**PAVEMENT MARKINGS**   

**PAVEMENT SECTION**                      DITCH

### VISUAL INSPECTION SUMMARY

TYPE OF DISTRESS	SEVERITY			
	NONE	LIGHT	MODERATE	SEVERE
ALLIGATOR CRACKING	<input type="checkbox"/>	<input type="checkbox"/>	<input type="checkbox"/>	<input checked="" type="checkbox"/>
BLOCK/TRANSVERSE CRACKING	<input type="checkbox"/>	<input type="checkbox"/>	<input checked="" type="checkbox"/>	<input type="checkbox"/>
RUTTING	<input checked="" type="checkbox"/>	<input type="checkbox"/>	<input type="checkbox"/>	<input type="checkbox"/>
RAVELING	<input type="checkbox"/>	<input checked="" type="checkbox"/>	<input type="checkbox"/>	<input type="checkbox"/>
BLEEDING	<input checked="" type="checkbox"/>	<input type="checkbox"/>	<input type="checkbox"/>	<input type="checkbox"/>
EXISTING PATCHING	<input type="checkbox"/>	<input checked="" type="checkbox"/>	<input type="checkbox"/>	<input type="checkbox"/>
 OVERALL RIDE QUALITY	GOOD <input type="checkbox"/>	FAIR <input checked="" type="checkbox"/>	POOR <input type="checkbox"/>	
OVERALL ROAD CONDITION	GOOD <input type="checkbox"/>	FAIR <input type="checkbox"/>	POOR <input checked="" type="checkbox"/>	

**COMMENTS:**

This roadway segment has not been resurfaced. Roadway construction appears to be original.

# 2024 ROADWAY INSPECTION REPORT

## TOWN OF RIVER BEND, NORTH CAROLINA

**ROAD NAME**                      LAUREN COURT

**TRAFFIC LOADING**

THOROUGHFARE	<input type="checkbox"/>
COLLECTOR	<input type="checkbox"/>
LOCAL	<input checked="" type="checkbox"/>

**PRIORITY NUMBER**

**APPROXIMATE LENGTH**    270 LF

**AVERAGE WIDTH**                      18 LF

**TOTAL PAVEMENT AREA (SQUARE YARDS)**    621 SY

**PAVEMENT MARKINGS**   

**PAVEMENT SECTION**                      INVERTED PAVEMENT

### VISUAL INSPECTION SUMMARY

TYPE OF DISTRESS	SEVERITY			
	NONE	LIGHT	MODERATE	SEVERE
ALLIGATOR CRACKING	<input type="checkbox"/>	<input type="checkbox"/>	<input checked="" type="checkbox"/>	<input type="checkbox"/>
BLOCK/TRANSVERSE CRACKING	<input type="checkbox"/>	<input type="checkbox"/>	<input checked="" type="checkbox"/>	<input type="checkbox"/>
RUTTING	<input checked="" type="checkbox"/>	<input type="checkbox"/>	<input type="checkbox"/>	<input type="checkbox"/>
RAVELING	<input checked="" type="checkbox"/>	<input type="checkbox"/>	<input type="checkbox"/>	<input type="checkbox"/>
BLEEDING	<input checked="" type="checkbox"/>	<input type="checkbox"/>	<input type="checkbox"/>	<input type="checkbox"/>
EXISTING PATCHING	<input type="checkbox"/>	<input checked="" type="checkbox"/>	<input type="checkbox"/>	<input type="checkbox"/>
 OVERALL RIDE QUALITY	GOOD <input type="checkbox"/>	FAIR <input checked="" type="checkbox"/>	POOR <input type="checkbox"/>	
OVERALL ROAD CONDITION	GOOD <input type="checkbox"/>	FAIR <input checked="" type="checkbox"/>	POOR <input type="checkbox"/>	

**COMMENTS:**

This roadway segment has not been resurfaced. Roadway construction appears to be original.

## 2024 ROADWAY INSPECTION REPORT TOWN OF RIVER BEND, NORTH CAROLINA

**ROAD NAME**                    LOCHBRIDGE

**TRAFFIC LOADING**

THOROUGHFARE	<input type="checkbox"/>
COLLECTOR	<input checked="" type="checkbox"/>
LOCAL	<input type="checkbox"/>

**PRIORITY NUMBER**

**APPROXIMATE LENGTH**    1,590 LF

**AVERAGE WIDTH**            20 LF

**TOTAL PAVEMENT AREA (SQUARE YARDS)**    4,063 SY

**PAVEMENT MARKINGS**   

**PAVEMENT SECTION**        DITCH

### VISUAL INSPECTION SUMMARY

TYPE OF DISTRESS	SEVERITY			
	NONE	LIGHT	MODERATE	SEVERE
ALLIGATOR CRACKING	<input type="checkbox"/>	<input checked="" type="checkbox"/>	<input type="checkbox"/>	<input type="checkbox"/>
BLOCK/TRANSVERSE CRACKING	<input checked="" type="checkbox"/>	<input type="checkbox"/>	<input type="checkbox"/>	<input type="checkbox"/>
RUTTING	<input checked="" type="checkbox"/>	<input type="checkbox"/>	<input type="checkbox"/>	<input type="checkbox"/>
RAVELING	<input type="checkbox"/>	<input checked="" type="checkbox"/>	<input type="checkbox"/>	<input type="checkbox"/>
BLEEDING	<input checked="" type="checkbox"/>	<input type="checkbox"/>	<input type="checkbox"/>	<input type="checkbox"/>
EXISTING PATCHING	<input checked="" type="checkbox"/>	<input type="checkbox"/>	<input type="checkbox"/>	<input type="checkbox"/>
 OVERALL RIDE QUALITY	GOOD <input checked="" type="checkbox"/>	FAIR <input type="checkbox"/>	POOR <input type="checkbox"/>	
OVERALL ROAD CONDITION	GOOD <input checked="" type="checkbox"/>	FAIR <input type="checkbox"/>	POOR <input type="checkbox"/>	

**COMMENTS:**

This road segment was resurfaced as a part of the 2016 Paving Program.

## 2024 ROADWAY INSPECTION REPORT TOWN OF RIVER BEND, NORTH CAROLINA

**ROAD NAME** MARGO COURT

**TRAFFIC LOADING**  
 THOROUGHFARE   
 COLLECTOR   
 LOCAL

**PRIORITY NUMBER**

**APPROXIMATE LENGTH** 160 LF

**AVERAGE WIDTH** 18 LF

**TOTAL PAVEMENT AREA (SQUARE YARDS)** 368 SY

**PAVEMENT MARKINGS**

**PAVEMENT SECTION** INVERTED PAVEMENT

### VISUAL INSPECTION SUMMARY

TYPE OF DISTRESS	SEVERITY			
	NONE	LIGHT	MODERATE	SEVERE
ALLIGATOR CRACKING	<input type="checkbox"/>	<input type="checkbox"/>	<input type="checkbox"/>	<input checked="" type="checkbox"/>
BLOCK/TRANSVERSE CRACKING	<input type="checkbox"/>	<input type="checkbox"/>	<input checked="" type="checkbox"/>	<input type="checkbox"/>
RUTTING	<input checked="" type="checkbox"/>	<input type="checkbox"/>	<input type="checkbox"/>	<input type="checkbox"/>
RAVELING	<input checked="" type="checkbox"/>	<input type="checkbox"/>	<input type="checkbox"/>	<input type="checkbox"/>
BLEEDING	<input checked="" type="checkbox"/>	<input type="checkbox"/>	<input type="checkbox"/>	<input type="checkbox"/>
EXISTING PATCHING	<input type="checkbox"/>	<input type="checkbox"/>	<input checked="" type="checkbox"/>	<input type="checkbox"/>
OVERALL RIDE QUALITY	GOOD <input type="checkbox"/>	FAIR <input type="checkbox"/>	POOR <input checked="" type="checkbox"/>	
OVERALL ROAD CONDITION	GOOD <input type="checkbox"/>	FAIR <input type="checkbox"/>	POOR <input checked="" type="checkbox"/>	

**COMMENTS:**

This roadway segment has not been resurfaced. Roadway construction appears to be original.



## 2024 ROADWAY INSPECTION REPORT TOWN OF RIVER BEND, NORTH CAROLINA

**ROAD NAME**                      MARINA ROAD

	THOROUGHFARE <input type="checkbox"/>
<b>TRAFFIC LOADING</b>	COLLECTOR <input type="checkbox"/>
	LOCAL <input checked="" type="checkbox"/>

**PRIORITY NUMBER**

**APPROXIMATE LENGTH**    475 LF

**AVERAGE WIDTH**            18 LF

**TOTAL PAVEMENT AREA (SQUARE YARDS)**    1,045 SY

**PAVEMENT MARKINGS**   

**PAVEMENT SECTION**        DITCH

### VISUAL INSPECTION SUMMARY

TYPE OF DISTRESS	SEVERITY			
	NONE	LIGHT	MODERATE	SEVERE
ALLIGATOR CRACKING	<input type="checkbox"/>	<input type="checkbox"/>	<input type="checkbox"/>	<input checked="" type="checkbox"/>
BLOCK/TRANSVERSE CRACKING	<input type="checkbox"/>	<input type="checkbox"/>	<input checked="" type="checkbox"/>	<input type="checkbox"/>
RUTTING	<input type="checkbox"/>	<input checked="" type="checkbox"/>	<input type="checkbox"/>	<input type="checkbox"/>
RAVELING	<input type="checkbox"/>	<input checked="" type="checkbox"/>	<input type="checkbox"/>	<input type="checkbox"/>
BLEEDING	<input checked="" type="checkbox"/>	<input type="checkbox"/>	<input type="checkbox"/>	<input type="checkbox"/>
EXISTING PATCHING	<input type="checkbox"/>	<input type="checkbox"/>	<input checked="" type="checkbox"/>	<input type="checkbox"/>
OVERALL RIDE QUALITY	GOOD <input type="checkbox"/>	FAIR <input type="checkbox"/>	POOR <input checked="" type="checkbox"/>	
OVERALL ROAD CONDITION	GOOD <input type="checkbox"/>	FAIR <input type="checkbox"/>	POOR <input checked="" type="checkbox"/>	

**COMMENTS:**

This roadway segment has not been resurfaced. Roadway construction appears to be original.

## 2024 ROADWAY INSPECTION REPORT TOWN OF RIVER BEND, NORTH CAROLINA

**ROAD NAME**                      MARINERS COURT

	THOROUGHFARE <input type="checkbox"/>
<b>TRAFFIC LOADING</b>	COLLECTOR <input type="checkbox"/>
	LOCAL <input checked="" type="checkbox"/>

**PRIORITY NUMBER**

**APPROXIMATE LENGTH**    480 LF

**AVERAGE WIDTH**            18 LF

**TOTAL PAVEMENT AREA (SQUARE YARDS)**    1,100 SY

**PAVEMENT MARKINGS**   

**PAVEMENT SECTION**        DITCH

### VISUAL INSPECTION SUMMARY

TYPE OF DISTRESS	SEVERITY			
	NONE	LIGHT	MODERATE	SEVERE
ALLIGATOR CRACKING	<input type="checkbox"/>	<input type="checkbox"/>	<input checked="" type="checkbox"/>	<input type="checkbox"/>
BLOCK/TRANSVERSE CRACKING	<input type="checkbox"/>	<input type="checkbox"/>	<input checked="" type="checkbox"/>	<input type="checkbox"/>
RUTTING	<input type="checkbox"/>	<input checked="" type="checkbox"/>	<input type="checkbox"/>	<input type="checkbox"/>
RAVELING	<input type="checkbox"/>	<input type="checkbox"/>	<input checked="" type="checkbox"/>	<input type="checkbox"/>
BLEEDING	<input checked="" type="checkbox"/>	<input type="checkbox"/>	<input type="checkbox"/>	<input type="checkbox"/>
EXISTING PATCHING	<input type="checkbox"/>	<input checked="" type="checkbox"/>	<input type="checkbox"/>	<input type="checkbox"/>
 OVERALL RIDE QUALITY	GOOD <input type="checkbox"/>	FAIR <input checked="" type="checkbox"/>	POOR <input type="checkbox"/>	
OVERALL ROAD CONDITION	GOOD <input type="checkbox"/>	FAIR <input checked="" type="checkbox"/>	POOR <input type="checkbox"/>	

**COMMENTS:**

This road segment was resurfaced as a part of the 2000 Paving Program.

# 2024 ROADWAY INSPECTION REPORT

## TOWN OF RIVER BEND, NORTH CAROLINA

**ROAD NAME**                      MASSACHUSETTS ROAD

**TRAFFIC LOADING**

THOROUGHFARE	<input type="checkbox"/>
COLLECTOR	<input type="checkbox"/>
LOCAL	<input checked="" type="checkbox"/>

**PRIORITY NUMBER**

**APPROXIMATE LENGTH**    690 LF                                      **AVERAGE WIDTH**                      18 LF

**TOTAL PAVEMENT AREA (SQUARE YARDS)**    1,587 SY

**PAVEMENT MARKINGS**                                          **PAVEMENT SECTION**                      DITCH

### VISUAL INSPECTION SUMMARY

TYPE OF DISTRESS	SEVERITY			
	NONE	LIGHT	MODERATE	SEVERE
ALLIGATOR CRACKING	<input checked="" type="checkbox"/>	<input type="checkbox"/>	<input type="checkbox"/>	<input type="checkbox"/>
BLOCK/TRANSVERSE CRACKING	<input type="checkbox"/>	<input checked="" type="checkbox"/>	<input type="checkbox"/>	<input type="checkbox"/>
RUTTING	<input checked="" type="checkbox"/>	<input type="checkbox"/>	<input type="checkbox"/>	<input type="checkbox"/>
RAVELING	<input checked="" type="checkbox"/>	<input type="checkbox"/>	<input type="checkbox"/>	<input type="checkbox"/>
BLEEDING	<input checked="" type="checkbox"/>	<input type="checkbox"/>	<input type="checkbox"/>	<input type="checkbox"/>
EXISTING PATCHING	<input checked="" type="checkbox"/>	<input type="checkbox"/>	<input type="checkbox"/>	<input type="checkbox"/>
OVERALL RIDE QUALITY	GOOD <input checked="" type="checkbox"/>	FAIR <input type="checkbox"/>	POOR <input type="checkbox"/>	
OVERALL ROAD CONDITION	GOOD <input checked="" type="checkbox"/>	FAIR <input type="checkbox"/>	POOR <input type="checkbox"/>	

**COMMENTS:**

This road segment was resurfaced as a part of the 2015 Paving Program.

## 2024 ROADWAY INSPECTION REPORT TOWN OF RIVER BEND, NORTH CAROLINA

**ROAD NAME**                    MASTER COURT

**TRAFFIC LOADING**

THOROUGHFARE	<input type="checkbox"/>
COLLECTOR	<input type="checkbox"/>
LOCAL	<input checked="" type="checkbox"/>

**PRIORITY NUMBER**

**APPROXIMATE LENGTH**    660 LF

**AVERAGE WIDTH**            23 LF

**TOTAL PAVEMENT AREA (SQUARE YARDS)**    1,940 SY

**PAVEMENT MARKINGS**   

**PAVEMENT SECTION**        CURB & GUTTER

### VISUAL INSPECTION SUMMARY

TYPE OF DISTRESS	SEVERITY			
	NONE	LIGHT	MODERATE	SEVERE
ALLIGATOR CRACKING	<input type="checkbox"/>	<input checked="" type="checkbox"/>	<input type="checkbox"/>	<input type="checkbox"/>
BLOCK/TRANSVERSE CRACKING	<input type="checkbox"/>	<input type="checkbox"/>	<input checked="" type="checkbox"/>	<input type="checkbox"/>
RUTTING	<input type="checkbox"/>	<input checked="" type="checkbox"/>	<input type="checkbox"/>	<input type="checkbox"/>
RAVELING	<input type="checkbox"/>	<input checked="" type="checkbox"/>	<input type="checkbox"/>	<input type="checkbox"/>
BLEEDING	<input checked="" type="checkbox"/>	<input type="checkbox"/>	<input type="checkbox"/>	<input type="checkbox"/>
EXISTING PATCHING	<input type="checkbox"/>	<input checked="" type="checkbox"/>	<input type="checkbox"/>	<input type="checkbox"/>
 OVERALL RIDE QUALITY	GOOD <input type="checkbox"/>	FAIR <input checked="" type="checkbox"/>	POOR <input type="checkbox"/>	
OVERALL ROAD CONDITION	GOOD <input type="checkbox"/>	FAIR <input checked="" type="checkbox"/>	POOR <input type="checkbox"/>	

**COMMENTS:**

This road segment was resurfaced as a part of the 2002 and 2011 Paving Program.

## 2024 ROADWAY INSPECTION REPORT TOWN OF RIVER BEND, NORTH CAROLINA

**ROAD NAME** MULBERRY LANE (EAST/WEST)

**TRAFFIC LOADING** THOROUGHFARE   
COLLECTOR   
LOCAL

**PRIORITY NUMBER**

**APPROXIMATE LENGTH** 1,175 LF **AVERAGE WIDTH** 23 LF

**TOTAL PAVEMENT AREA (SQUARE YARDS)** 3,003 SY

**PAVEMENT MARKINGS**  **PAVEMENT SECTION** CURB & GUTTER

### VISUAL INSPECTION SUMMARY

TYPE OF DISTRESS	SEVERITY			
	NONE	LIGHT	MODERATE	SEVERE
ALLIGATOR CRACKING	<input type="checkbox"/>	<input checked="" type="checkbox"/>	<input type="checkbox"/>	<input type="checkbox"/>
BLOCK/TRANSVERSE CRACKING	<input type="checkbox"/>	<input checked="" type="checkbox"/>	<input type="checkbox"/>	<input type="checkbox"/>
RUTTING	<input checked="" type="checkbox"/>	<input type="checkbox"/>	<input type="checkbox"/>	<input type="checkbox"/>
RAVELING	<input checked="" type="checkbox"/>	<input type="checkbox"/>	<input type="checkbox"/>	<input type="checkbox"/>
BLEEDING	<input checked="" type="checkbox"/>	<input type="checkbox"/>	<input type="checkbox"/>	<input type="checkbox"/>
EXISTING PATCHING	<input checked="" type="checkbox"/>	<input type="checkbox"/>	<input type="checkbox"/>	<input type="checkbox"/>
OVERALL RIDE QUALITY	GOOD <input checked="" type="checkbox"/>	FAIR <input type="checkbox"/>	POOR <input type="checkbox"/>	
OVERALL ROAD CONDITION	GOOD <input checked="" type="checkbox"/>	FAIR <input type="checkbox"/>	POOR <input type="checkbox"/>	

**COMMENTS:**

This road segment was resurfaced as a part of the 2002 Paving Program.

# 2024 ROADWAY INSPECTION REPORT

## TOWN OF RIVER BEND, NORTH CAROLINA

**ROAD NAME** MULBERRY LANE (NORTH/SOUTH)

**TRAFFIC LOADING** THOROUGHFARE   
 COLLECTOR   
 LOCAL

**PRIORITY NUMBER**

**APPROXIMATE LENGTH** 530 LF

**AVERAGE WIDTH** 23 LF

**TOTAL PAVEMENT AREA (SQUARE YARDS)** 1,558 SY

**PAVEMENT MARKINGS**

**PAVEMENT SECTION** CURB & GUTTER

### VISUAL INSPECTION SUMMARY

TYPE OF DISTRESS	SEVERITY			
	NONE	LIGHT	MODERATE	SEVERE
ALLIGATOR CRACKING	<input type="checkbox"/>	<input checked="" type="checkbox"/>	<input type="checkbox"/>	<input type="checkbox"/>
BLOCK/TRANSVERSE CRACKING	<input type="checkbox"/>	<input checked="" type="checkbox"/>	<input type="checkbox"/>	<input type="checkbox"/>
RUTTING	<input checked="" type="checkbox"/>	<input type="checkbox"/>	<input type="checkbox"/>	<input type="checkbox"/>
RAVELING	<input checked="" type="checkbox"/>	<input type="checkbox"/>	<input type="checkbox"/>	<input type="checkbox"/>
BLEEDING	<input checked="" type="checkbox"/>	<input type="checkbox"/>	<input type="checkbox"/>	<input type="checkbox"/>
EXISTING PATCHING	<input checked="" type="checkbox"/>	<input type="checkbox"/>	<input type="checkbox"/>	<input type="checkbox"/>
OVERALL RIDE QUALITY	GOOD <input checked="" type="checkbox"/>	FAIR <input type="checkbox"/>	POOR <input type="checkbox"/>	
OVERALL ROAD CONDITION	GOOD <input checked="" type="checkbox"/>	FAIR <input type="checkbox"/>	POOR <input type="checkbox"/>	

**COMMENTS:**

This road segment was resurfaced as a part of the 2013 Paving Program.

## 2024 ROADWAY INSPECTION REPORT TOWN OF RIVER BEND, NORTH CAROLINA

**ROAD NAME** NAUTICAL DRIVE

**TRAFFIC LOADING**  
 THOROUGHFARE   
 COLLECTOR   
 LOCAL

**PRIORITY NUMBER**

**APPROXIMATE LENGTH** 210 LF

**AVERAGE WIDTH** 18 LF

**TOTAL PAVEMENT AREA (SQUARE YARDS)** 483 SY

**PAVEMENT MARKINGS**

**PAVEMENT SECTION** DITCH

### VISUAL INSPECTION SUMMARY

TYPE OF DISTRESS	SEVERITY			
	NONE	LIGHT	MODERATE	SEVERE
ALLIGATOR CRACKING	<input checked="" type="checkbox"/>	<input type="checkbox"/>	<input type="checkbox"/>	<input type="checkbox"/>
BLOCK/TRANSVERSE CRACKING	<input type="checkbox"/>	<input checked="" type="checkbox"/>	<input type="checkbox"/>	<input type="checkbox"/>
RUTTING	<input checked="" type="checkbox"/>	<input type="checkbox"/>	<input type="checkbox"/>	<input type="checkbox"/>
RAVELING	<input checked="" type="checkbox"/>	<input type="checkbox"/>	<input type="checkbox"/>	<input type="checkbox"/>
BLEEDING	<input checked="" type="checkbox"/>	<input type="checkbox"/>	<input type="checkbox"/>	<input type="checkbox"/>
EXISTING PATCHING	<input checked="" type="checkbox"/>	<input type="checkbox"/>	<input type="checkbox"/>	<input type="checkbox"/>
OVERALL RIDE QUALITY	GOOD <input checked="" type="checkbox"/>	FAIR <input type="checkbox"/>	POOR <input type="checkbox"/>	
OVERALL ROAD CONDITION	GOOD <input checked="" type="checkbox"/>	FAIR <input type="checkbox"/>	POOR <input type="checkbox"/>	

**COMMENTS:**

This road segment was resurfaced as a part of the 2000 Paving Program.

## 2024 ROADWAY INSPECTION REPORT TOWN OF RIVER BEND, NORTH CAROLINA

**ROAD NAME**                      NEW HAMPSHIRE LANE

**TRAFFIC LOADING**

THOROUGHFARE	<input type="checkbox"/>
COLLECTOR	<input type="checkbox"/>
LOCAL	<input checked="" type="checkbox"/>

**PRIORITY NUMBER**

**APPROXIMATE LENGTH**    635 LF                                      **AVERAGE WIDTH**                      18 LF

**TOTAL PAVEMENT AREA (SQUARE YARDS)**    1,460 SY

**PAVEMENT MARKINGS**                                          **PAVEMENT SECTION**                      DITCH

### VISUAL INSPECTION SUMMARY

TYPE OF DISTRESS	SEVERITY			
	NONE	LIGHT	MODERATE	SEVERE
ALLIGATOR CRACKING	<input type="checkbox"/>	<input type="checkbox"/>	<input checked="" type="checkbox"/>	<input type="checkbox"/>
BLOCK/TRANSVERSE CRACKING	<input type="checkbox"/>	<input type="checkbox"/>	<input checked="" type="checkbox"/>	<input type="checkbox"/>
RUTTING	<input checked="" type="checkbox"/>	<input type="checkbox"/>	<input type="checkbox"/>	<input type="checkbox"/>
RAVELING	<input checked="" type="checkbox"/>	<input type="checkbox"/>	<input type="checkbox"/>	<input type="checkbox"/>
BLEEDING	<input checked="" type="checkbox"/>	<input type="checkbox"/>	<input type="checkbox"/>	<input type="checkbox"/>
EXISTING PATCHING	<input type="checkbox"/>	<input checked="" type="checkbox"/>	<input type="checkbox"/>	<input type="checkbox"/>
OVERALL RIDE QUALITY	GOOD <input type="checkbox"/>	FAIR <input checked="" type="checkbox"/>	POOR <input type="checkbox"/>	
OVERALL ROAD CONDITION	GOOD <input type="checkbox"/>	FAIR <input checked="" type="checkbox"/>	POOR <input type="checkbox"/>	

**COMMENTS:**

This road segment to be resurfaced as a part of the 2024 Paving Program.



## 2024 ROADWAY INSPECTION REPORT TOWN OF RIVER BEND, NORTH CAROLINA

**ROAD NAME** NORBURY DRIVE

**TRAFFIC LOADING**  
 THOROUGHFARE   
 COLLECTOR   
 LOCAL

**PRIORITY NUMBER**

**APPROXIMATE LENGTH** 1,955 LF

**AVERAGE WIDTH** 19 LF

**TOTAL PAVEMENT AREA (SQUARE YARDS)** 4,497 SY

**PAVEMENT MARKINGS** ■

**PAVEMENT SECTION** DITCH

### VISUAL INSPECTION SUMMARY

TYPE OF DISTRESS	SEVERITY			
	NONE	LIGHT	MODERATE	SEVERE
ALLIGATOR CRACKING	<input type="checkbox"/>	<input type="checkbox"/>	<input type="checkbox"/>	<input checked="" type="checkbox"/>
BLOCK/TRANSVERSE CRACKING	<input type="checkbox"/>	<input type="checkbox"/>	<input type="checkbox"/>	<input checked="" type="checkbox"/>
RUTTING	<input type="checkbox"/>	<input checked="" type="checkbox"/>	<input type="checkbox"/>	<input type="checkbox"/>
RAVELING	<input type="checkbox"/>	<input checked="" type="checkbox"/>	<input type="checkbox"/>	<input type="checkbox"/>
BLEEDING	<input checked="" type="checkbox"/>	<input type="checkbox"/>	<input type="checkbox"/>	<input type="checkbox"/>
EXISTING PATCHING	<input type="checkbox"/>	<input type="checkbox"/>	<input checked="" type="checkbox"/>	<input type="checkbox"/>
OVERALL RIDE QUALITY	GOOD <input type="checkbox"/>	FAIR <input type="checkbox"/>	POOR <input checked="" type="checkbox"/>	
OVERALL ROAD CONDITION	GOOD <input type="checkbox"/>	FAIR <input type="checkbox"/>	POOR <input checked="" type="checkbox"/>	

**COMMENTS:**

This roadway segment has not been resurfaced. Roadway construction appears to be original.

## 2024 ROADWAY INSPECTION REPORT TOWN OF RIVER BEND, NORTH CAROLINA

**ROAD NAME** NORTH CAROLINA DRIVE

**TRAFFIC LOADING**  
 THOROUGHFARE   
 COLLECTOR   
 LOCAL

**PRIORITY NUMBER**

**APPROXIMATE LENGTH** 1,165 LF

**AVERAGE WIDTH** 18 LF

**TOTAL PAVEMENT AREA (SQUARE YARDS)** 2,680 SY

**PAVEMENT MARKINGS**

**PAVEMENT SECTION** DITCH

### VISUAL INSPECTION SUMMARY

TYPE OF DISTRESS	SEVERITY			
	NONE	LIGHT	MODERATE	SEVERE
ALLIGATOR CRACKING	<input checked="" type="checkbox"/>	<input type="checkbox"/>	<input type="checkbox"/>	<input type="checkbox"/>
BLOCK/TRANSVERSE CRACKING	<input checked="" type="checkbox"/>	<input type="checkbox"/>	<input type="checkbox"/>	<input type="checkbox"/>
RUTTING	<input checked="" type="checkbox"/>	<input type="checkbox"/>	<input type="checkbox"/>	<input type="checkbox"/>
RAVELING	<input checked="" type="checkbox"/>	<input type="checkbox"/>	<input type="checkbox"/>	<input type="checkbox"/>
BLEEDING	<input checked="" type="checkbox"/>	<input type="checkbox"/>	<input type="checkbox"/>	<input type="checkbox"/>
EXISTING PATCHING	<input checked="" type="checkbox"/>	<input type="checkbox"/>	<input type="checkbox"/>	<input type="checkbox"/>
OVERALL RIDE QUALITY	GOOD <input checked="" type="checkbox"/>	FAIR <input type="checkbox"/>	POOR <input type="checkbox"/>	
OVERALL ROAD CONDITION	GOOD <input checked="" type="checkbox"/>	FAIR <input type="checkbox"/>	POOR <input type="checkbox"/>	

**COMMENTS:**

This road segment was resurfaced as a part of the 2019 Paving Program.



## 2024 ROADWAY INSPECTION REPORT TOWN OF RIVER BEND, NORTH CAROLINA

**ROAD NAME** O'HARA DRIVE

**TRAFFIC LOADING**  
 THOROUGHFARE   
 COLLECTOR   
 LOCAL

**PRIORITY NUMBER**

**APPROXIMATE LENGTH** LF

**AVERAGE WIDTH** LF

**TOTAL PAVEMENT AREA (SQUARE YARDS)** SY

**PAVEMENT MARKINGS**

**PAVEMENT SECTION** SHOULDER

### VISUAL INSPECTION SUMMARY

TYPE OF DISTRESS	SEVERITY			
	NONE	LIGHT	MODERATE	SEVERE
ALLIGATOR CRACKING	<input checked="" type="checkbox"/>	<input type="checkbox"/>	<input type="checkbox"/>	<input type="checkbox"/>
BLOCK/TRANSVERSE CRACKING	<input checked="" type="checkbox"/>	<input type="checkbox"/>	<input type="checkbox"/>	<input type="checkbox"/>
RUTTING	<input checked="" type="checkbox"/>	<input type="checkbox"/>	<input type="checkbox"/>	<input type="checkbox"/>
RAVELING	<input checked="" type="checkbox"/>	<input type="checkbox"/>	<input type="checkbox"/>	<input type="checkbox"/>
BLEEDING	<input checked="" type="checkbox"/>	<input type="checkbox"/>	<input type="checkbox"/>	<input type="checkbox"/>
EXISTING PATCHING	<input checked="" type="checkbox"/>	<input type="checkbox"/>	<input type="checkbox"/>	<input type="checkbox"/>
OVERALL RIDE QUALITY	GOOD <input checked="" type="checkbox"/>	FAIR <input type="checkbox"/>	POOR <input type="checkbox"/>	
OVERALL ROAD CONDITION	GOOD <input checked="" type="checkbox"/>	FAIR <input type="checkbox"/>	POOR <input type="checkbox"/>	

**COMMENTS:**

This road segment was resurfaced as a part of the 2021 Paving Program.

## 2024 ROADWAY INSPECTION REPORT TOWN OF RIVER BEND, NORTH CAROLINA

**ROAD NAME** OLD POLLOCKSVILLE ROAD

**TRAFFIC LOADING** THOROUGHFARE   
COLLECTOR   
LOCAL

**PRIORITY NUMBER**

**APPROXIMATE LENGTH** 1,700 LF

**AVERAGE WIDTH** 18 LF

**TOTAL PAVEMENT AREA (SQUARE YARDS)** 3,400 SY

**PAVEMENT MARKINGS**

**PAVEMENT SECTION** DITCH

### VISUAL INSPECTION SUMMARY

TYPE OF DISTRESS	SEVERITY			
	NONE	LIGHT	MODERATE	SEVERE
ALLIGATOR CRACKING	<input type="checkbox"/>	<input type="checkbox"/>	<input checked="" type="checkbox"/>	<input type="checkbox"/>
BLOCK/TRANSVERSE CRACKING	<input type="checkbox"/>	<input type="checkbox"/>	<input checked="" type="checkbox"/>	<input type="checkbox"/>
RUTTING	<input checked="" type="checkbox"/>	<input type="checkbox"/>	<input type="checkbox"/>	<input type="checkbox"/>
RAVELING	<input checked="" type="checkbox"/>	<input type="checkbox"/>	<input type="checkbox"/>	<input type="checkbox"/>
BLEEDING	<input checked="" type="checkbox"/>	<input type="checkbox"/>	<input type="checkbox"/>	<input type="checkbox"/>
EXISTING PATCHING	<input checked="" type="checkbox"/>	<input type="checkbox"/>	<input type="checkbox"/>	<input type="checkbox"/>
OVERALL RIDE QUALITY	GOOD <input type="checkbox"/>	FAIR <input checked="" type="checkbox"/>	POOR <input type="checkbox"/>	
OVERALL ROAD CONDITION	GOOD <input type="checkbox"/>	FAIR <input checked="" type="checkbox"/>	POOR <input type="checkbox"/>	

**COMMENTS:**

This road segment was resurfaced as a part of the 2014 Paving Program.

## 2024 ROADWAY INSPECTION REPORT TOWN OF RIVER BEND, NORTH CAROLINA

**ROAD NAME**                      OUTRIGGER ROAD

	THOROUGHFARE <input type="checkbox"/>
<b>TRAFFIC LOADING</b>	COLLECTOR <input type="checkbox"/>
	LOCAL <input checked="" type="checkbox"/>

**PRIORITY NUMBER**

<b>APPROXIMATE LENGTH</b> 850 LF	<b>AVERAGE WIDTH</b> 18 LF
----------------------------------	----------------------------

**TOTAL PAVEMENT AREA (SQUARE YARDS)**    1,955 SY

<b>PAVEMENT MARKINGS</b> <input type="checkbox"/>	<b>PAVEMENT SECTION</b> DITCH
---	-------------------------------

### VISUAL INSPECTION SUMMARY

TYPE OF DISTRESS	SEVERITY			
	NONE	LIGHT	MODERATE	SEVERE
ALLIGATOR CRACKING	<input type="checkbox"/>	<input checked="" type="checkbox"/>	<input type="checkbox"/>	<input type="checkbox"/>
BLOCK/TRANSVERSE CRACKING	<input type="checkbox"/>	<input checked="" type="checkbox"/>	<input type="checkbox"/>	<input type="checkbox"/>
RUTTING	<input checked="" type="checkbox"/>	<input type="checkbox"/>	<input type="checkbox"/>	<input type="checkbox"/>
RAVELING	<input checked="" type="checkbox"/>	<input type="checkbox"/>	<input type="checkbox"/>	<input type="checkbox"/>
BLEEDING	<input checked="" type="checkbox"/>	<input type="checkbox"/>	<input type="checkbox"/>	<input type="checkbox"/>
EXISTING PATCHING	<input type="checkbox"/>	<input type="checkbox"/>	<input checked="" type="checkbox"/>	<input type="checkbox"/>
OVERALL RIDE QUALITY	GOOD <input type="checkbox"/>	FAIR <input checked="" type="checkbox"/>	POOR <input type="checkbox"/>	
OVERALL ROAD CONDITION	GOOD <input checked="" type="checkbox"/>	FAIR <input type="checkbox"/>	POOR <input type="checkbox"/>	

**COMMENTS:**

This road segment was resurfaced as a part of the 2000 Paving Program.

## 2024 ROADWAY INSPECTION REPORT TOWN OF RIVER BEND, NORTH CAROLINA

**ROAD NAME**                      PARKWOOD COURT

**TRAFFIC LOADING**

THOROUGHFARE	<input type="checkbox"/>
COLLECTOR	<input type="checkbox"/>
LOCAL	<input checked="" type="checkbox"/>

**PRIORITY NUMBER**

**APPROXIMATE LENGTH**    110 LF                                      **AVERAGE WIDTH**                      18 LF

**TOTAL PAVEMENT AREA (SQUARE YARDS)**    253 SY

**PAVEMENT MARKINGS**                                          **PAVEMENT SECTION**                      DITCH

### VISUAL INSPECTION SUMMARY

TYPE OF DISTRESS	SEVERITY			
	NONE	LIGHT	MODERATE	SEVERE
ALLIGATOR CRACKING	<input type="checkbox"/>	<input checked="" type="checkbox"/>	<input type="checkbox"/>	<input type="checkbox"/>
BLOCK/TRANSVERSE CRACKING	<input type="checkbox"/>	<input checked="" type="checkbox"/>	<input type="checkbox"/>	<input type="checkbox"/>
RUTTING	<input checked="" type="checkbox"/>	<input type="checkbox"/>	<input type="checkbox"/>	<input type="checkbox"/>
RAVELING	<input checked="" type="checkbox"/>	<input type="checkbox"/>	<input type="checkbox"/>	<input type="checkbox"/>
BLEEDING	<input checked="" type="checkbox"/>	<input type="checkbox"/>	<input type="checkbox"/>	<input type="checkbox"/>
EXISTING PATCHING	<input checked="" type="checkbox"/>	<input type="checkbox"/>	<input type="checkbox"/>	<input type="checkbox"/>
OVERALL RIDE QUALITY	GOOD <input checked="" type="checkbox"/>	FAIR <input type="checkbox"/>	POOR <input type="checkbox"/>	
OVERALL ROAD CONDITION	GOOD <input checked="" type="checkbox"/>	FAIR <input type="checkbox"/>	POOR <input type="checkbox"/>	

**COMMENTS:**

This road segment was resurfaced as a part to the 2006 Paving Program.

## 2024 ROADWAY INSPECTION REPORT TOWN OF RIVER BEND, NORTH CAROLINA

**ROAD NAME** PIER POINTE

**TRAFFIC LOADING**  
 THOROUGHFARE   
 COLLECTOR   
 LOCAL

**PRIORITY NUMBER**

**APPROXIMATE LENGTH** 1,802 LF

**AVERAGE WIDTH** 21 LF

**TOTAL PAVEMENT AREA (SQUARE YARDS)** 4,204 SY

**PAVEMENT MARKINGS**

**PAVEMENT SECTION** INVERTED PAVEMENT

### VISUAL INSPECTION SUMMARY

TYPE OF DISTRESS	SEVERITY			
	NONE	LIGHT	MODERATE	SEVERE
ALLIGATOR CRACKING	<input type="checkbox"/>	<input type="checkbox"/>	<input checked="" type="checkbox"/>	<input type="checkbox"/>
BLOCK/TRANSVERSE CRACKING	<input type="checkbox"/>	<input type="checkbox"/>	<input checked="" type="checkbox"/>	<input type="checkbox"/>
RUTTING	<input checked="" type="checkbox"/>	<input type="checkbox"/>	<input type="checkbox"/>	<input type="checkbox"/>
RAVELING	<input type="checkbox"/>	<input checked="" type="checkbox"/>	<input type="checkbox"/>	<input type="checkbox"/>
BLEEDING	<input checked="" type="checkbox"/>	<input type="checkbox"/>	<input type="checkbox"/>	<input type="checkbox"/>
EXISTING PATCHING	<input type="checkbox"/>	<input type="checkbox"/>	<input type="checkbox"/>	<input checked="" type="checkbox"/>
OVERALL RIDE QUALITY	GOOD <input type="checkbox"/>	FAIR <input checked="" type="checkbox"/>	POOR <input type="checkbox"/>	
OVERALL ROAD CONDITION	GOOD <input type="checkbox"/>	FAIR <input type="checkbox"/>	POOR <input checked="" type="checkbox"/>	

**COMMENTS:**

This roadway segment has not been resurfaced. Roadway construction appears to be original.



## 2024 ROADWAY INSPECTION REPORT TOWN OF RIVER BEND, NORTH CAROLINA

<b>ROAD NAME</b>	PILLORY CIRCLE		
		<b>TRAFFIC LOADING</b>	THOROUGHFARE <input type="checkbox"/>
			COLLECTOR <input type="checkbox"/>
			LOCAL <input checked="" type="checkbox"/>
<b>PRIORITY NUMBER</b>			
<b>APPROXIMATE LENGTH</b>	LF	<b>AVERAGE WIDTH</b>	LF
<b>TOTAL PAVEMENT AREA (SQUARE YARDS)</b>	SY		
<b>PAVEMENT MARKINGS</b>	<input type="checkbox"/>	<b>PAVEMENT SECTION</b>	SHOULDER

### VISUAL INSPECTION SUMMARY

TYPE OF DISTRESS	SEVERITY			
	NONE	LIGHT	MODERATE	SEVERE
ALLIGATOR CRACKING	<input checked="" type="checkbox"/>	<input type="checkbox"/>	<input type="checkbox"/>	<input type="checkbox"/>
BLOCK/TRANSVERSE CRACKING	<input checked="" type="checkbox"/>	<input type="checkbox"/>	<input type="checkbox"/>	<input type="checkbox"/>
RUTTING	<input checked="" type="checkbox"/>	<input type="checkbox"/>	<input type="checkbox"/>	<input type="checkbox"/>
RAVELING	<input checked="" type="checkbox"/>	<input type="checkbox"/>	<input type="checkbox"/>	<input type="checkbox"/>
BLEEDING	<input checked="" type="checkbox"/>	<input type="checkbox"/>	<input type="checkbox"/>	<input type="checkbox"/>
EXISTING PATCHING	<input checked="" type="checkbox"/>	<input type="checkbox"/>	<input type="checkbox"/>	<input type="checkbox"/>
OVERALL RIDE QUALITY	GOOD <input checked="" type="checkbox"/>	FAIR <input type="checkbox"/>	POOR <input type="checkbox"/>	
OVERALL ROAD CONDITION	GOOD <input checked="" type="checkbox"/>	FAIR <input type="checkbox"/>	POOR <input type="checkbox"/>	

**COMMENTS:**

This road segment was resurfaced as a part of the 2021 Paving Program.

## 2024 ROADWAY INSPECTION REPORT TOWN OF RIVER BEND, NORTH CAROLINA

**ROAD NAME**

PILOT PLACE

**TRAFFIC LOADING**  
 THOROUGHFARE   
 COLLECTOR   
 LOCAL

**PRIORITY NUMBER**

**APPROXIMATE LENGTH** 160 LF

**AVERAGE WIDTH** 18 LF

**TOTAL PAVEMENT AREA (SQUARE YARDS)** 368 SY

**PAVEMENT MARKINGS**

**PAVEMENT SECTION** DITCH

### VISUAL INSPECTION SUMMARY

TYPE OF DISTRESS	SEVERITY			
	NONE	LIGHT	MODERATE	SEVERE
ALLIGATOR CRACKING	<input type="checkbox"/>	<input type="checkbox"/>	<input type="checkbox"/>	<input checked="" type="checkbox"/>
BLOCK/TRANSVERSE CRACKING	<input type="checkbox"/>	<input type="checkbox"/>	<input type="checkbox"/>	<input checked="" type="checkbox"/>
RUTTING	<input checked="" type="checkbox"/>	<input type="checkbox"/>	<input type="checkbox"/>	<input type="checkbox"/>
RAVELING	<input type="checkbox"/>	<input type="checkbox"/>	<input checked="" type="checkbox"/>	<input type="checkbox"/>
BLEEDING	<input checked="" type="checkbox"/>	<input type="checkbox"/>	<input type="checkbox"/>	<input type="checkbox"/>
EXISTING PATCHING	<input type="checkbox"/>	<input checked="" type="checkbox"/>	<input type="checkbox"/>	<input type="checkbox"/>
OVERALL RIDE QUALITY	GOOD <input type="checkbox"/>	FAIR <input checked="" type="checkbox"/>	POOR <input type="checkbox"/>	
OVERALL ROAD CONDITION	GOOD <input type="checkbox"/>	FAIR <input type="checkbox"/>	POOR <input checked="" type="checkbox"/>	

**COMMENTS:**

This roadway segment has not been resurfaced. Roadway construction appears to be original.

## 2024 ROADWAY INSPECTION REPORT TOWN OF RIVER BEND, NORTH CAROLINA

**ROAD NAME**                      PINEWOOD DRIVE

**TRAFFIC LOADING**  
 THOROUGHFARE      
 COLLECTOR              
 LOCAL                   

**PRIORITY NUMBER**

**APPROXIMATE LENGTH**    2,010 LF                                      **AVERAGE WIDTH**                      18 LF

**TOTAL PAVEMENT AREA (SQUARE YARDS)**    4,623 SY

**PAVEMENT MARKINGS**                                          **PAVEMENT SECTION**                      DITCH

### VISUAL INSPECTION SUMMARY

TYPE OF DISTRESS	SEVERITY			
	NONE	LIGHT	MODERATE	SEVERE
ALLIGATOR CRACKING	<input checked="" type="checkbox"/>	<input type="checkbox"/>	<input type="checkbox"/>	<input type="checkbox"/>
BLOCK/TRANSVERSE CRACKING	<input checked="" type="checkbox"/>	<input type="checkbox"/>	<input type="checkbox"/>	<input type="checkbox"/>
RUTTING	<input checked="" type="checkbox"/>	<input type="checkbox"/>	<input type="checkbox"/>	<input type="checkbox"/>
RAVELING	<input checked="" type="checkbox"/>	<input type="checkbox"/>	<input type="checkbox"/>	<input type="checkbox"/>
BLEEDING	<input checked="" type="checkbox"/>	<input type="checkbox"/>	<input type="checkbox"/>	<input type="checkbox"/>
EXISTING PATCHING	<input checked="" type="checkbox"/>	<input type="checkbox"/>	<input type="checkbox"/>	<input type="checkbox"/>
OVERALL RIDE QUALITY	GOOD <input checked="" type="checkbox"/>	FAIR <input type="checkbox"/>	POOR <input type="checkbox"/>	
OVERALL ROAD CONDITION	GOOD <input checked="" type="checkbox"/>	FAIR <input type="checkbox"/>	POOR <input type="checkbox"/>	

**COMMENTS:**

This road segment was resurfaced as a part of the 2023 Paving Program.

## 2024 ROADWAY INSPECTION REPORT TOWN OF RIVER BEND, NORTH CAROLINA

**ROAD NAME** PIRATES ROAD – SHORELINE DRIVE TO WAKEFIELD DRIVE

	THOROUGHFARE <input checked="" type="checkbox"/>
<b>TRAFFIC LOADING</b>	COLLECTOR <input type="checkbox"/>
	LOCAL <input type="checkbox"/>

**PRIORITY NUMBER**

**APPROXIMATE LENGTH** 3,273 LF **AVERAGE WIDTH** 20 LF

**TOTAL PAVEMENT AREA (SQUARE YARDS)** 10,664 SY

**PAVEMENT MARKINGS**  **PAVEMENT SECTION** DITCH

### VISUAL INSPECTION SUMMARY

TYPE OF DISTRESS	SEVERITY			
	NONE	LIGHT	MODERATE	SEVERE
ALLIGATOR CRACKING	<input type="checkbox"/>	<input type="checkbox"/>	<input checked="" type="checkbox"/>	<input type="checkbox"/>
BLOCK/TRANSVERSE CRACKING	<input type="checkbox"/>	<input type="checkbox"/>	<input checked="" type="checkbox"/>	<input type="checkbox"/>
RUTTING	<input type="checkbox"/>	<input checked="" type="checkbox"/>	<input type="checkbox"/>	<input type="checkbox"/>
RAVELING	<input type="checkbox"/>	<input checked="" type="checkbox"/>	<input type="checkbox"/>	<input type="checkbox"/>
BLEEDING	<input checked="" type="checkbox"/>	<input type="checkbox"/>	<input type="checkbox"/>	<input type="checkbox"/>
EXISTING PATCHING	<input type="checkbox"/>	<input type="checkbox"/>	<input checked="" type="checkbox"/>	<input type="checkbox"/>
OVERALL RIDE QUALITY	GOOD <input type="checkbox"/>	FAIR <input type="checkbox"/>	POOR <input checked="" type="checkbox"/>	
OVERALL ROAD CONDITION	GOOD <input type="checkbox"/>	FAIR <input checked="" type="checkbox"/>	POOR <input type="checkbox"/>	

**COMMENTS:**

This road segment was resurfaced as a part of the 2003 Paving Program.

# 2024 ROADWAY INSPECTION REPORT

## TOWN OF RIVER BEND, NORTH CAROLINA

**ROAD NAME** PIRATES ROAD – WAKEFIELD DRIVE TO HIGHWAY 17

**TRAFFIC LOADING**

THOROUGHFARE

COLLECTOR

LOCAL

**PRIORITY NUMBER**

**APPROXIMATE LENGTH** 900 LF **AVERAGE WIDTH** 20 LF

**TOTAL PAVEMENT AREA (SQUARE YARDS)** 10,664 SY

**PAVEMENT MARKINGS**  **PAVEMENT SECTION** DITCH

### VISUAL INSPECTION SUMMARY

TYPE OF DISTRESS	SEVERITY			
	NONE	LIGHT	MODERATE	SEVERE
ALLIGATOR CRACKING	<input type="checkbox"/>	<input type="checkbox"/>	<input checked="" type="checkbox"/>	<input type="checkbox"/>
BLOCK/TRANSVERSE CRACKING	<input type="checkbox"/>	<input checked="" type="checkbox"/>	<input type="checkbox"/>	<input type="checkbox"/>
RUTTING	<input type="checkbox"/>	<input checked="" type="checkbox"/>	<input type="checkbox"/>	<input type="checkbox"/>
RAVELING	<input checked="" type="checkbox"/>	<input type="checkbox"/>	<input type="checkbox"/>	<input type="checkbox"/>
BLEEDING	<input checked="" type="checkbox"/>	<input type="checkbox"/>	<input type="checkbox"/>	<input type="checkbox"/>
EXISTING PATCHING	<input type="checkbox"/>	<input checked="" type="checkbox"/>	<input type="checkbox"/>	<input type="checkbox"/>
 OVERALL RIDE QUALITY	GOOD <input type="checkbox"/>	FAIR <input checked="" type="checkbox"/>	POOR <input type="checkbox"/>	
OVERALL ROAD CONDITION	GOOD <input type="checkbox"/>	FAIR <input checked="" type="checkbox"/>	POOR <input type="checkbox"/>	

**COMMENTS:**

This roadway segment was resurfaced as a part of the 2003 Paving Program.

## 2024 ROADWAY INSPECTION REPORT TOWN OF RIVER BEND, NORTH CAROLINA

**ROAD NAME** PLANTATION DRIVE – GULL POINTE TO SHORELINE (SOUTH)

**TRAFFIC LOADING** THOROUGHFARE   
COLLECTOR   
LOCAL

**PRIORITY NUMBER**

**APPROXIMATE LENGTH** 3,605 LF **AVERAGE WIDTH** 20 LF

**TOTAL PAVEMENT AREA (SQUARE YARDS)** 9,213 SY

**PAVEMENT MARKINGS**  **PAVEMENT SECTION** DITCH

### VISUAL INSPECTION SUMMARY

TYPE OF DISTRESS	SEVERITY			
	NONE	LIGHT	MODERATE	SEVERE
ALLIGATOR CRACKING	<input type="checkbox"/>	<input type="checkbox"/>	<input checked="" type="checkbox"/>	<input type="checkbox"/>
BLOCK/TRANSVERSE CRACKING	<input type="checkbox"/>	<input checked="" type="checkbox"/>	<input type="checkbox"/>	<input type="checkbox"/>
RUTTING	<input type="checkbox"/>	<input checked="" type="checkbox"/>	<input type="checkbox"/>	<input type="checkbox"/>
RAVELING	<input type="checkbox"/>	<input checked="" type="checkbox"/>	<input type="checkbox"/>	<input type="checkbox"/>
BLEEDING	<input checked="" type="checkbox"/>	<input type="checkbox"/>	<input type="checkbox"/>	<input type="checkbox"/>
EXISTING PATCHING	<input type="checkbox"/>	<input checked="" type="checkbox"/>	<input type="checkbox"/>	<input type="checkbox"/>
OVERALL RIDE QUALITY	GOOD <input type="checkbox"/>	FAIR <input checked="" type="checkbox"/>	POOR <input type="checkbox"/>	
OVERALL ROAD CONDITION	GOOD <input type="checkbox"/>	FAIR <input checked="" type="checkbox"/>	POOR <input type="checkbox"/>	

**COMMENTS:**

This road segment was resurfaced as a part of the 2004 Paving Program.

# 2024 ROADWAY INSPECTION REPORT

## TOWN OF RIVER BEND, NORTH CAROLINA

**ROAD NAME** PLANTATION DRIVE – PINWOOD DRIVE TO WEST END

**TRAFFIC LOADING**  
 THOROUGHFARE   
 COLLECTOR   
 LOCAL

**PRIORITY NUMBER**

**APPROXIMATE LENGTH** 1,611 LF      **AVERAGE WIDTH** 18 LF

**TOTAL PAVEMENT AREA (SQUARE YARDS)** 3,222 SY

**PAVEMENT MARKINGS**       **PAVEMENT SECTION** DITCH

### VISUAL INSPECTION SUMMARY

TYPE OF DISTRESS	SEVERITY			
	NONE	LIGHT	MODERATE	SEVERE
ALLIGATOR CRACKING	<input checked="" type="checkbox"/>	<input type="checkbox"/>	<input type="checkbox"/>	<input type="checkbox"/>
BLOCK/TRANSVERSE CRACKING	<input checked="" type="checkbox"/>	<input type="checkbox"/>	<input type="checkbox"/>	<input type="checkbox"/>
RUTTING	<input checked="" type="checkbox"/>	<input type="checkbox"/>	<input type="checkbox"/>	<input type="checkbox"/>
RAVELING	<input checked="" type="checkbox"/>	<input type="checkbox"/>	<input type="checkbox"/>	<input type="checkbox"/>
BLEEDING	<input checked="" type="checkbox"/>	<input type="checkbox"/>	<input type="checkbox"/>	<input type="checkbox"/>
EXISTING PATCHING	<input checked="" type="checkbox"/>	<input type="checkbox"/>	<input type="checkbox"/>	<input type="checkbox"/>
OVERALL RIDE QUALITY	GOOD <input checked="" type="checkbox"/>	FAIR <input type="checkbox"/>	POOR <input type="checkbox"/>	
OVERALL ROAD CONDITION	GOOD <input checked="" type="checkbox"/>	FAIR <input type="checkbox"/>	POOR <input type="checkbox"/>	

**COMMENTS:**

This road segment was resurfaced as a part of the 2023 Paving Program.

## 2024 ROADWAY INSPECTION REPORT TOWN OF RIVER BEND, NORTH CAROLINA

**ROAD NAME** PLANTATION DRIVE – SHORELINE DRIVE TO PINWOOD DRIVE

**TRAFFIC LOADING**  
 THOROUGHFARE   
 COLLECTOR   
 LOCAL

**PRIORITY NUMBER**

**APPROXIMATE LENGTH** 2,344 LF **AVERAGE WIDTH** 18 LF

**TOTAL PAVEMENT AREA (SQUARE YARDS)** 2,688 SY

**PAVEMENT MARKINGS**  **PAVEMENT SECTION** DITCH

### VISUAL INSPECTION SUMMARY

TYPE OF DISTRESS	SEVERITY			
	NONE	LIGHT	MODERATE	SEVERE
ALLIGATOR CRACKING	<input type="checkbox"/>	<input checked="" type="checkbox"/>	<input type="checkbox"/>	<input type="checkbox"/>
BLOCK/TRANSVERSE CRACKING	<input checked="" type="checkbox"/>	<input type="checkbox"/>	<input type="checkbox"/>	<input type="checkbox"/>
RUTTING	<input checked="" type="checkbox"/>	<input type="checkbox"/>	<input type="checkbox"/>	<input type="checkbox"/>
RAVELING	<input checked="" type="checkbox"/>	<input type="checkbox"/>	<input type="checkbox"/>	<input type="checkbox"/>
BLEEDING	<input checked="" type="checkbox"/>	<input type="checkbox"/>	<input type="checkbox"/>	<input type="checkbox"/>
EXISTING PATCHING	<input checked="" type="checkbox"/>	<input type="checkbox"/>	<input type="checkbox"/>	<input type="checkbox"/>
OVERALL RIDE QUALITY	GOOD <input checked="" type="checkbox"/>	FAIR <input type="checkbox"/>	POOR <input type="checkbox"/>	
OVERALL ROAD CONDITION	GOOD <input checked="" type="checkbox"/>	FAIR <input type="checkbox"/>	POOR <input type="checkbox"/>	

**COMMENTS:**

This road segment was resurfaced as a part of the 2005 Paving Program.



# 2024 ROADWAY INSPECTION REPORT

## TOWN OF RIVER BEND, NORTH CAROLINA

**ROAD NAME** PLANTATION DRIVE – SHORELINE NORTH TO GULL POINTE

**TRAFFIC LOADING**

THOROUGHFARE

COLLECTOR

LOCAL

**PRIORITY NUMBER**

**APPROXIMATE LENGTH** 10,471 LF **AVERAGE WIDTH** 20 LF

**TOTAL PAVEMENT AREA (SQUARE YARDS)** 16,602 SY

**PAVEMENT MARKINGS**  **PAVEMENT SECTION** DITCH

### VISUAL INSPECTION SUMMARY

TYPE OF DISTRESS	SEVERITY			
	NONE	LIGHT	MODERATE	SEVERE
ALLIGATOR CRACKING	<input type="checkbox"/>	<input checked="" type="checkbox"/>	<input type="checkbox"/>	<input type="checkbox"/>
BLOCK/TRANSVERSE CRACKING	<input type="checkbox"/>	<input checked="" type="checkbox"/>	<input type="checkbox"/>	<input type="checkbox"/>
RUTTING	<input checked="" type="checkbox"/>	<input type="checkbox"/>	<input type="checkbox"/>	<input type="checkbox"/>
RAVELING	<input checked="" type="checkbox"/>	<input type="checkbox"/>	<input type="checkbox"/>	<input type="checkbox"/>
BLEEDING	<input checked="" type="checkbox"/>	<input type="checkbox"/>	<input type="checkbox"/>	<input type="checkbox"/>
EXISTING PATCHING	<input type="checkbox"/>	<input checked="" type="checkbox"/>	<input type="checkbox"/>	<input type="checkbox"/>
OVERALL RIDE QUALITY	GOOD <input type="checkbox"/>	FAIR <input checked="" type="checkbox"/>	POOR <input type="checkbox"/>	
OVERALL ROAD CONDITION	GOOD <input checked="" type="checkbox"/>	FAIR <input type="checkbox"/>	POOR <input type="checkbox"/>	

**COMMENTS:**

This road segment was resurfaced as a part of the 2009 and 2004 Paving Programs.



# 2024 ROADWAY INSPECTION REPORT

## TOWN OF RIVER BEND, NORTH CAROLINA

**ROAD NAME**                      QUARTERDECK ROAD CLUSTER III

**TRAFFIC LOADING**

THOROUGHFARE   

COLLECTOR           

LOCAL                   

**PRIORITY NUMBER**

**APPROXIMATE LENGTH**    900 LF

**AVERAGE WIDTH**            20 LF

**TOTAL PAVEMENT AREA (SQUARE YARDS)**    SY

**PAVEMENT MARKINGS**   

**PAVEMENT SECTION**            INVERTED PAVEMENT

### VISUAL INSPECTION SUMMARY

#### SEVERITY

TYPE OF DISTRESS	NONE	LIGHT	MODERATE	SEVERE
ALLIGATOR CRACKING	<input type="checkbox"/>	<input checked="" type="checkbox"/>	<input type="checkbox"/>	<input type="checkbox"/>
BLOCK/TRANSVERSE CRACKING	<input type="checkbox"/>	<input checked="" type="checkbox"/>	<input type="checkbox"/>	<input type="checkbox"/>
RUTTING	<input checked="" type="checkbox"/>	<input type="checkbox"/>	<input type="checkbox"/>	<input type="checkbox"/>
RAVELING	<input checked="" type="checkbox"/>	<input type="checkbox"/>	<input type="checkbox"/>	<input type="checkbox"/>
BLEEDING	<input checked="" type="checkbox"/>	<input type="checkbox"/>	<input type="checkbox"/>	<input type="checkbox"/>
EXISTING PATCHING	<input checked="" type="checkbox"/>	<input type="checkbox"/>	<input type="checkbox"/>	<input type="checkbox"/>
OVERALL RIDE QUALITY	GOOD <input checked="" type="checkbox"/>	FAIR <input type="checkbox"/>	POOR <input type="checkbox"/>	
OVERALL ROAD CONDITION	GOOD <input checked="" type="checkbox"/>	FAIR <input type="checkbox"/>	POOR <input type="checkbox"/>	

**COMMENTS:**

# 2024 ROADWAY INSPECTION REPORT

## TOWN OF RIVER BEND, NORTH CAROLINA

**ROAD NAME**                      QUARTERDECK CLUSTER I AND II

**TRAFFIC LOADING**

THOROUGHFARE   

COLLECTOR           

LOCAL                   

**PRIORITY NUMBER**

**APPROXIMATE LENGTH**    1,800 LF

**AVERAGE WIDTH**            20 LF

**TOTAL PAVEMENT AREA (SQUARE YARDS)**    2,688 SY

**PAVEMENT MARKINGS**   

**PAVEMENT SECTION**

### VISUAL INSPECTION SUMMARY

#### SEVERITY

TYPE OF DISTRESS	NONE	LIGHT	MODERATE	SEVERE
ALLIGATOR CRACKING	<input type="checkbox"/>	<input type="checkbox"/>	<input checked="" type="checkbox"/>	<input type="checkbox"/>
BLOCK/TRANSVERSE CRACKING	<input type="checkbox"/>	<input checked="" type="checkbox"/>	<input type="checkbox"/>	<input type="checkbox"/>
RUTTING	<input checked="" type="checkbox"/>	<input type="checkbox"/>	<input type="checkbox"/>	<input type="checkbox"/>
RAVELING	<input checked="" type="checkbox"/>	<input type="checkbox"/>	<input type="checkbox"/>	<input type="checkbox"/>
BLEEDING	<input checked="" type="checkbox"/>	<input type="checkbox"/>	<input type="checkbox"/>	<input type="checkbox"/>
EXISTING PATCHING	<input type="checkbox"/>	<input checked="" type="checkbox"/>	<input type="checkbox"/>	<input type="checkbox"/>
OVERALL RIDE QUALITY	GOOD <input type="checkbox"/>	FAIR <input type="checkbox"/>	POOR <input checked="" type="checkbox"/>	
OVERALL ROAD CONDITION	GOOD <input type="checkbox"/>	FAIR <input checked="" type="checkbox"/>	POOR <input type="checkbox"/>	

**COMMENTS:**

## 2024 ROADWAY INSPECTION REPORT TOWN OF RIVER BEND, NORTH CAROLINA

**ROAD NAME**                      RAFT ROAD

**TRAFFIC LOADING**

THOROUGHFARE	<input type="checkbox"/>
COLLECTOR	<input type="checkbox"/>
LOCAL	<input checked="" type="checkbox"/>

**PRIORITY NUMBER**

**APPROXIMATE LENGTH**    320 LF

**AVERAGE WIDTH**            18 LF

**TOTAL PAVEMENT AREA (SQUARE YARDS)**    736 SY

**PAVEMENT MARKINGS**   

**PAVEMENT SECTION**        DITCH

### VISUAL INSPECTION SUMMARY

TYPE OF DISTRESS	SEVERITY			
	NONE	LIGHT	MODERATE	SEVERE
ALLIGATOR CRACKING	<input type="checkbox"/>	<input checked="" type="checkbox"/>	<input type="checkbox"/>	<input type="checkbox"/>
BLOCK/TRANSVERSE CRACKING	<input type="checkbox"/>	<input checked="" type="checkbox"/>	<input type="checkbox"/>	<input type="checkbox"/>
RUTTING	<input checked="" type="checkbox"/>	<input type="checkbox"/>	<input type="checkbox"/>	<input type="checkbox"/>
RAVELING	<input checked="" type="checkbox"/>	<input type="checkbox"/>	<input type="checkbox"/>	<input type="checkbox"/>
BLEEDING	<input checked="" type="checkbox"/>	<input type="checkbox"/>	<input type="checkbox"/>	<input type="checkbox"/>
EXISTING PATCHING	<input type="checkbox"/>	<input checked="" type="checkbox"/>	<input type="checkbox"/>	<input type="checkbox"/>
 OVERALL RIDE QUALITY	GOOD <input checked="" type="checkbox"/>	FAIR <input type="checkbox"/>	POOR <input type="checkbox"/>	
OVERALL ROAD CONDITION	GOOD <input checked="" type="checkbox"/>	FAIR <input type="checkbox"/>	POOR <input type="checkbox"/>	

**COMMENTS:**

This road segment was resurfaced as a part of the 2013 Paving Program.

## 2024 ROADWAY INSPECTION REPORT TOWN OF RIVER BEND, NORTH CAROLINA

**ROAD NAME**                      RANDOMWOOD LANE

**TRAFFIC LOADING**

THOROUGHFARE	<input type="checkbox"/>
COLLECTOR	<input checked="" type="checkbox"/>
LOCAL	<input type="checkbox"/>

**PRIORITY NUMBER**

**APPROXIMATE LENGTH**    1,540 LF                                      **AVERAGE WIDTH**                      18 LF

**TOTAL PAVEMENT AREA (SQUARE YARDS)**    3,542 SY

**PAVEMENT MARKINGS**                                          **PAVEMENT SECTION**                      DITCH

### VISUAL INSPECTION SUMMARY

TYPE OF DISTRESS	SEVERITY			
	NONE	LIGHT	MODERATE	SEVERE
ALLIGATOR CRACKING	<input type="checkbox"/>	<input type="checkbox"/>	<input checked="" type="checkbox"/>	<input type="checkbox"/>
BLOCK/TRANSVERSE CRACKING	<input type="checkbox"/>	<input checked="" type="checkbox"/>	<input type="checkbox"/>	<input type="checkbox"/>
RUTTING	<input checked="" type="checkbox"/>	<input type="checkbox"/>	<input type="checkbox"/>	<input type="checkbox"/>
RAVELING	<input checked="" type="checkbox"/>	<input type="checkbox"/>	<input type="checkbox"/>	<input type="checkbox"/>
BLEEDING	<input checked="" type="checkbox"/>	<input type="checkbox"/>	<input type="checkbox"/>	<input type="checkbox"/>
EXISTING PATCHING	<input checked="" type="checkbox"/>	<input type="checkbox"/>	<input type="checkbox"/>	<input type="checkbox"/>
OVERALL RIDE QUALITY	GOOD <input type="checkbox"/>	FAIR <input checked="" type="checkbox"/>	POOR <input type="checkbox"/>	
OVERALL ROAD CONDITION	GOOD <input type="checkbox"/>	FAIR <input checked="" type="checkbox"/>	POOR <input type="checkbox"/>	

**COMMENTS:**

This road segment was resurfaced as a part of the 2000 Paving Program.

## 2024 ROADWAY INSPECTION REPORT TOWN OF RIVER BEND, NORTH CAROLINA

**ROAD NAME**                      ROCKLEDGE ROAD

	THOROUGHFARE <input checked="" type="checkbox"/>
<b>TRAFFIC LOADING</b>	COLLECTOR <input type="checkbox"/>
	LOCAL <input type="checkbox"/>

**PRIORITY NUMBER**

<b>APPROXIMATE LENGTH</b> 3,220 LF	<b>AVERAGE WIDTH</b> 20 LF
------------------------------------	----------------------------

**TOTAL PAVEMENT AREA (SQUARE YARDS)**    8,229 SY

<b>PAVEMENT MARKINGS</b> <input checked="" type="checkbox"/>	<b>PAVEMENT SECTION</b> DITCH
--	-------------------------------

### VISUAL INSPECTION SUMMARY

TYPE OF DISTRESS	SEVERITY			
	NONE	LIGHT	MODERATE	SEVERE
ALLIGATOR CRACKING	<input type="checkbox"/>	<input type="checkbox"/>	<input checked="" type="checkbox"/>	<input type="checkbox"/>
BLOCK/TRANSVERSE CRACKING	<input type="checkbox"/>	<input type="checkbox"/>	<input checked="" type="checkbox"/>	<input type="checkbox"/>
RUTTING	<input checked="" type="checkbox"/>	<input type="checkbox"/>	<input type="checkbox"/>	<input type="checkbox"/>
RAVELING	<input checked="" type="checkbox"/>	<input type="checkbox"/>	<input type="checkbox"/>	<input type="checkbox"/>
BLEEDING	<input checked="" type="checkbox"/>	<input type="checkbox"/>	<input type="checkbox"/>	<input type="checkbox"/>
EXISTING PATCHING	<input type="checkbox"/>	<input checked="" type="checkbox"/>	<input type="checkbox"/>	<input type="checkbox"/>
OVERALL RIDE QUALITY	GOOD <input type="checkbox"/>	FAIR <input checked="" type="checkbox"/>	POOR <input type="checkbox"/>	
OVERALL ROAD CONDITION	GOOD <input type="checkbox"/>	FAIR <input checked="" type="checkbox"/>	POOR <input type="checkbox"/>	

**COMMENTS:**

This road segment was resurfaced as a part of the 2000 Paving Program.

# 2024 ROADWAY INSPECTION REPORT

## TOWN OF RIVER BEND, NORTH CAROLINA

**ROAD NAME** SAILORS COURT

**TRAFFIC LOADING**  
 THOROUGHFARE   
 COLLECTOR   
 LOCAL

**PRIORITY NUMBER**

**APPROXIMATE LENGTH** 320 LF

**AVERAGE WIDTH** 18 LF

**TOTAL PAVEMENT AREA (SQUARE YARDS)** 736 SY

**PAVEMENT MARKINGS**

**PAVEMENT SECTION** DITCH

### VISUAL INSPECTION SUMMARY

TYPE OF DISTRESS	SEVERITY			
	NONE	LIGHT	MODERATE	SEVERE
ALLIGATOR CRACKING	<input checked="" type="checkbox"/>	<input type="checkbox"/>	<input type="checkbox"/>	<input type="checkbox"/>
BLOCK/TRANSVERSE CRACKING	<input checked="" type="checkbox"/>	<input type="checkbox"/>	<input type="checkbox"/>	<input type="checkbox"/>
RUTTING	<input checked="" type="checkbox"/>	<input type="checkbox"/>	<input type="checkbox"/>	<input type="checkbox"/>
RAVELING	<input checked="" type="checkbox"/>	<input type="checkbox"/>	<input type="checkbox"/>	<input type="checkbox"/>
BLEEDING	<input checked="" type="checkbox"/>	<input type="checkbox"/>	<input type="checkbox"/>	<input type="checkbox"/>
EXISTING PATCHING	<input type="checkbox"/>	<input checked="" type="checkbox"/>	<input type="checkbox"/>	<input type="checkbox"/>
OVERALL RIDE QUALITY	GOOD <input checked="" type="checkbox"/>	FAIR <input type="checkbox"/>	POOR <input type="checkbox"/>	
OVERALL ROAD CONDITION	GOOD <input checked="" type="checkbox"/>	FAIR <input type="checkbox"/>	POOR <input type="checkbox"/>	

**COMMENTS:**

This road segment was resurfaced as a part of the 2012 Paving Program.



## 2024 ROADWAY INSPECTION REPORT TOWN OF RIVER BEND, NORTH CAROLINA

**ROAD NAME** SANDPIPER COURT

**TRAFFIC LOADING**  
 THOROUGHFARE   
 COLLECTOR   
 LOCAL

**PRIORITY NUMBER**

**APPROXIMATE LENGTH** 425 LF

**AVERAGE WIDTH** 18 LF

**TOTAL PAVEMENT AREA (SQUARE YARDS)** 978 SY

**PAVEMENT MARKINGS**

**PAVEMENT SECTION** DITCH

### VISUAL INSPECTION SUMMARY

TYPE OF DISTRESS	SEVERITY			
	NONE	LIGHT	MODERATE	SEVERE
ALLIGATOR CRACKING	<input type="checkbox"/>	<input checked="" type="checkbox"/>	<input type="checkbox"/>	<input type="checkbox"/>
BLOCK/TRANSVERSE CRACKING	<input type="checkbox"/>	<input checked="" type="checkbox"/>	<input type="checkbox"/>	<input type="checkbox"/>
RUTTING	<input checked="" type="checkbox"/>	<input type="checkbox"/>	<input type="checkbox"/>	<input type="checkbox"/>
RAVELING	<input checked="" type="checkbox"/>	<input type="checkbox"/>	<input type="checkbox"/>	<input type="checkbox"/>
BLEEDING	<input checked="" type="checkbox"/>	<input type="checkbox"/>	<input type="checkbox"/>	<input type="checkbox"/>
EXISTING PATCHING	<input type="checkbox"/>	<input checked="" type="checkbox"/>	<input type="checkbox"/>	<input type="checkbox"/>
OVERALL RIDE QUALITY	GOOD <input type="checkbox"/>	FAIR <input checked="" type="checkbox"/>	POOR <input type="checkbox"/>	
OVERALL ROAD CONDITION	GOOD <input type="checkbox"/>	FAIR <input checked="" type="checkbox"/>	POOR <input type="checkbox"/>	

**COMMENTS:**

This road segment was resurfaced as a part of the 2017 Paving Program.

NOTE: Cul-de-sac not resurfaced.

# 2024 ROADWAY INSPECTION REPORT

## TOWN OF RIVER BEND, NORTH CAROLINA

**ROAD NAME** SEAFARERS COURT

**TRAFFIC LOADING**  
 THOROUGHFARE   
 COLLECTOR   
 LOCAL

**PRIORITY NUMBER**

**APPROXIMATE LENGTH** 270 LF

**AVERAGE WIDTH** 18 LF

**TOTAL PAVEMENT AREA (SQUARE YARDS)** 621 SY

**PAVEMENT MARKINGS**

**PAVEMENT SECTION** DITCH

### VISUAL INSPECTION SUMMARY

TYPE OF DISTRESS	SEVERITY			
	NONE	LIGHT	MODERATE	SEVERE
ALLIGATOR CRACKING	<input type="checkbox"/>	<input checked="" type="checkbox"/>	<input type="checkbox"/>	<input type="checkbox"/>
BLOCK/TRANSVERSE CRACKING	<input checked="" type="checkbox"/>	<input type="checkbox"/>	<input type="checkbox"/>	<input type="checkbox"/>
RUTTING	<input checked="" type="checkbox"/>	<input type="checkbox"/>	<input type="checkbox"/>	<input type="checkbox"/>
RAVELING	<input checked="" type="checkbox"/>	<input type="checkbox"/>	<input type="checkbox"/>	<input type="checkbox"/>
BLEEDING	<input checked="" type="checkbox"/>	<input type="checkbox"/>	<input type="checkbox"/>	<input type="checkbox"/>
EXISTING PATCHING	<input type="checkbox"/>	<input checked="" type="checkbox"/>	<input type="checkbox"/>	<input type="checkbox"/>
OVERALL RIDE QUALITY	GOOD <input checked="" type="checkbox"/>	FAIR <input type="checkbox"/>	POOR <input type="checkbox"/>	
OVERALL ROAD CONDITION	GOOD <input checked="" type="checkbox"/>	FAIR <input type="checkbox"/>	POOR <input type="checkbox"/>	

**COMMENTS:**

This road segment was resurfaced as a part of the 2012 Paving Program.

## 2024 ROADWAY INSPECTION REPORT TOWN OF RIVER BEND, NORTH CAROLINA

**ROAD NAME**                      SEXTANT COURT

**TRAFFIC LOADING**

THOROUGHFARE	<input type="checkbox"/>
COLLECTOR	<input type="checkbox"/>
LOCAL	<input checked="" type="checkbox"/>

**PRIORITY NUMBER**

**APPROXIMATE LENGTH**    215 LF                                      **AVERAGE WIDTH**                      18 LF

**TOTAL PAVEMENT AREA (SQUARE YARDS)**    495 SY

**PAVEMENT MARKINGS**                                          **PAVEMENT SECTION**                      DITCH

### VISUAL INSPECTION SUMMARY

TYPE OF DISTRESS	SEVERITY			
	NONE	LIGHT	MODERATE	SEVERE
ALLIGATOR CRACKING	<input type="checkbox"/>	<input checked="" type="checkbox"/>	<input type="checkbox"/>	<input type="checkbox"/>
BLOCK/TRANSVERSE CRACKING	<input type="checkbox"/>	<input checked="" type="checkbox"/>	<input type="checkbox"/>	<input type="checkbox"/>
RUTTING	<input checked="" type="checkbox"/>	<input type="checkbox"/>	<input type="checkbox"/>	<input type="checkbox"/>
RAVELING	<input checked="" type="checkbox"/>	<input type="checkbox"/>	<input type="checkbox"/>	<input type="checkbox"/>
BLEEDING	<input checked="" type="checkbox"/>	<input type="checkbox"/>	<input type="checkbox"/>	<input type="checkbox"/>
EXISTING PATCHING	<input checked="" type="checkbox"/>	<input type="checkbox"/>	<input type="checkbox"/>	<input type="checkbox"/>
OVERALL RIDE QUALITY	GOOD <input checked="" type="checkbox"/>	FAIR <input type="checkbox"/>	POOR <input type="checkbox"/>	
OVERALL ROAD CONDITION	GOOD <input checked="" type="checkbox"/>	FAIR <input type="checkbox"/>	POOR <input type="checkbox"/>	

**COMMENTS:**

This road segment was resurfaced as a part of the 2013 Paving Program.

# 2024 ROADWAY INSPECTION REPORT

## TOWN OF RIVER BEND, NORTH CAROLINA

**ROAD NAME** SHORELINE DRIVE – INTERSECTION 17 TO PLANTATION SOUTH

**TRAFFIC LOADING**

THOROUGHFARE

COLLECTOR

LOCAL

**PRIORITY NUMBER**

**APPROXIMATE LENGTH** 7,695 LF **AVERAGE WIDTH** 28 LF

**TOTAL PAVEMENT AREA (SQUARE YARDS)** 23,940 SY

**PAVEMENT MARKINGS**  **PAVEMENT SECTION** DITCH

### VISUAL INSPECTION SUMMARY

TYPE OF DISTRESS	SEVERITY			
	NONE	LIGHT	MODERATE	SEVERE
ALLIGATOR CRACKING	<input type="checkbox"/>	<input type="checkbox"/>	<input checked="" type="checkbox"/>	<input type="checkbox"/>
BLOCK/TRANSVERSE CRACKING	<input type="checkbox"/>	<input checked="" type="checkbox"/>	<input type="checkbox"/>	<input type="checkbox"/>
RUTTING	<input type="checkbox"/>	<input type="checkbox"/>	<input checked="" type="checkbox"/>	<input type="checkbox"/>
RAVELING	<input checked="" type="checkbox"/>	<input type="checkbox"/>	<input type="checkbox"/>	<input type="checkbox"/>
BLEEDING	<input checked="" type="checkbox"/>	<input type="checkbox"/>	<input type="checkbox"/>	<input type="checkbox"/>
EXISTING PATCHING	<input type="checkbox"/>	<input type="checkbox"/>	<input checked="" type="checkbox"/>	<input type="checkbox"/>
OVERALL RIDE QUALITY	GOOD <input type="checkbox"/>	FAIR <input checked="" type="checkbox"/>	POOR <input type="checkbox"/>	
OVERALL ROAD CONDITION	GOOD <input type="checkbox"/>	FAIR <input checked="" type="checkbox"/>	POOR <input type="checkbox"/>	

**COMMENTS:**

This road segment was partially resurfaced as a part of the 2010, 2005 and 2002 Paving Programs.

## 2024 ROADWAY INSPECTION REPORT TOWN OF RIVER BEND, NORTH CAROLINA

**ROAD NAME** SHORELINE DRIVE – REMAINING SEGMENTS (PLANTATION SOUTH TO ROCKLEDGE)

**TRAFFIC LOADING**  
 THOROUGHFARE   
 COLLECTOR   
 LOCAL

**PRIORITY NUMBER**

**APPROXIMATE LENGTH** 7,097 LF

**AVERAGE WIDTH** 20 LF

**TOTAL PAVEMENT AREA (SQUARE YARDS)** 18,137 SY

**PAVEMENT MARKINGS**

**PAVEMENT SECTION** DITCH

### VISUAL INSPECTION SUMMARY

TYPE OF DISTRESS	SEVERITY			
	NONE	LIGHT	MODERATE	SEVERE
ALLIGATOR CRACKING	<input type="checkbox"/>	<input checked="" type="checkbox"/>	<input type="checkbox"/>	<input type="checkbox"/>
BLOCK/TRANSVERSE CRACKING	<input type="checkbox"/>	<input checked="" type="checkbox"/>	<input type="checkbox"/>	<input type="checkbox"/>
RUTTING	<input checked="" type="checkbox"/>	<input type="checkbox"/>	<input type="checkbox"/>	<input type="checkbox"/>
RAVELING	<input checked="" type="checkbox"/>	<input type="checkbox"/>	<input type="checkbox"/>	<input type="checkbox"/>
BLEEDING	<input checked="" type="checkbox"/>	<input type="checkbox"/>	<input type="checkbox"/>	<input type="checkbox"/>
EXISTING PATCHING	<input type="checkbox"/>	<input checked="" type="checkbox"/>	<input type="checkbox"/>	<input type="checkbox"/>
OVERALL RIDE QUALITY	GOOD <input type="checkbox"/>	FAIR <input checked="" type="checkbox"/>	POOR <input type="checkbox"/>	
OVERALL ROAD CONDITION	GOOD <input type="checkbox"/>	FAIR <input checked="" type="checkbox"/>	POOR <input type="checkbox"/>	

**COMMENTS:**

This road segment was resurfaced as a part of the 2000 Paving Program.

# 2024 ROADWAY INSPECTION REPORT

## TOWN OF RIVER BEND, NORTH CAROLINA

**ROAD NAME**                      STARBOARD DRIVE

	THOROUGHFARE <input type="checkbox"/>
<b>TRAFFIC LOADING</b>	COLLECTOR <input type="checkbox"/>
	LOCAL <input checked="" type="checkbox"/>

**PRIORITY NUMBER**

**APPROXIMATE LENGTH**    530 LF

**AVERAGE WIDTH**            18 LF

**TOTAL PAVEMENT AREA (SQUARE YARDS)**    1,219 SY

**PAVEMENT MARKINGS**   

**PAVEMENT SECTION**        DITCH

### VISUAL INSPECTION SUMMARY

TYPE OF DISTRESS	SEVERITY			
	NONE	LIGHT	MODERATE	SEVERE
ALLIGATOR CRACKING	<input type="checkbox"/>	<input checked="" type="checkbox"/>	<input type="checkbox"/>	<input type="checkbox"/>
BLOCK/TRANSVERSE CRACKING	<input type="checkbox"/>	<input checked="" type="checkbox"/>	<input type="checkbox"/>	<input type="checkbox"/>
RUTTING	<input checked="" type="checkbox"/>	<input type="checkbox"/>	<input type="checkbox"/>	<input type="checkbox"/>
RAVELING	<input checked="" type="checkbox"/>	<input type="checkbox"/>	<input type="checkbox"/>	<input type="checkbox"/>
BLEEDING	<input checked="" type="checkbox"/>	<input type="checkbox"/>	<input type="checkbox"/>	<input type="checkbox"/>
EXISTING PATCHING	<input type="checkbox"/>	<input checked="" type="checkbox"/>	<input type="checkbox"/>	<input type="checkbox"/>
OVERALL RIDE QUALITY	GOOD <input checked="" type="checkbox"/>	FAIR <input type="checkbox"/>	POOR <input type="checkbox"/>	
OVERALL ROAD CONDITION	GOOD <input checked="" type="checkbox"/>	FAIR <input type="checkbox"/>	POOR <input type="checkbox"/>	

**COMMENTS:**

This road segment was resurfaced as a part of the 2012 Paving Program.

## 2024 ROADWAY INSPECTION REPORT TOWN OF RIVER BEND, NORTH CAROLINA

**ROAD NAME**                      STILLWATER COURT

**TRAFFIC LOADING**

THOROUGHFARE	<input type="checkbox"/>
COLLECTOR	<input type="checkbox"/>
LOCAL	<input checked="" type="checkbox"/>

**PRIORITY NUMBER**

**APPROXIMATE LENGTH**    106 LF

**AVERAGE WIDTH**                      23 LF

**TOTAL PAVEMENT AREA (SQUARE YARDS)**    271 SY

**PAVEMENT MARKINGS**   

**PAVEMENT SECTION**                      CURB & GUTTER

### VISUAL INSPECTION SUMMARY

TYPE OF DISTRESS	SEVERITY			
	NONE	LIGHT	MODERATE	SEVERE
ALLIGATOR CRACKING	■	<input type="checkbox"/>	<input type="checkbox"/>	<input type="checkbox"/>
BLOCK/TRANSVERSE CRACKING	<input type="checkbox"/>	■	<input type="checkbox"/>	<input type="checkbox"/>
RUTTING	■	<input type="checkbox"/>	<input type="checkbox"/>	<input type="checkbox"/>
RAVELING	<input type="checkbox"/>	■	<input type="checkbox"/>	<input type="checkbox"/>
BLEEDING	■	<input type="checkbox"/>	<input type="checkbox"/>	<input type="checkbox"/>
EXISTING PATCHING	■	<input type="checkbox"/>	<input type="checkbox"/>	<input type="checkbox"/>
 OVERALL RIDE QUALITY	GOOD ■	FAIR <input type="checkbox"/>	POOR <input type="checkbox"/>	
OVERALL ROAD CONDITION	GOOD ■	FAIR <input type="checkbox"/>	POOR <input type="checkbox"/>	

**COMMENTS:**

This road segment was resurfaced as a part of the 2018 Paving Program.

## 2024 ROADWAY INSPECTION REPORT TOWN OF RIVER BEND, NORTH CAROLINA

**ROAD NAME**                      TAR LANDING

**TRAFFIC LOADING**

THOROUGHFARE	<input type="checkbox"/>
COLLECTOR	<input type="checkbox"/>
LOCAL	<input checked="" type="checkbox"/>

**PRIORITY NUMBER**

**APPROXIMATE LENGTH**    1,060 LF

**AVERAGE WIDTH**                      18 LF

**TOTAL PAVEMENT AREA (SQUARE YARDS)**    2,438 SY

**PAVEMENT MARKINGS**   

**PAVEMENT SECTION**                      DITCH

### VISUAL INSPECTION SUMMARY

TYPE OF DISTRESS	SEVERITY			
	NONE	LIGHT	MODERATE	SEVERE
ALLIGATOR CRACKING	<input type="checkbox"/>	<input checked="" type="checkbox"/>	<input type="checkbox"/>	<input type="checkbox"/>
BLOCK/TRANSVERSE CRACKING	<input checked="" type="checkbox"/>	<input type="checkbox"/>	<input type="checkbox"/>	<input type="checkbox"/>
RUTTING	<input checked="" type="checkbox"/>	<input type="checkbox"/>	<input type="checkbox"/>	<input type="checkbox"/>
RAVELING	<input checked="" type="checkbox"/>	<input type="checkbox"/>	<input type="checkbox"/>	<input type="checkbox"/>
BLEEDING	<input checked="" type="checkbox"/>	<input type="checkbox"/>	<input type="checkbox"/>	<input type="checkbox"/>
EXISTING PATCHING	<input checked="" type="checkbox"/>	<input type="checkbox"/>	<input type="checkbox"/>	<input type="checkbox"/>
OVERALL RIDE QUALITY	GOOD <input checked="" type="checkbox"/>	FAIR <input type="checkbox"/>	POOR <input type="checkbox"/>	
OVERALL ROAD CONDITION	GOOD <input checked="" type="checkbox"/>	FAIR <input type="checkbox"/>	POOR <input type="checkbox"/>	

**COMMENTS:**

This road segment was resurfaced as a part of the 2006 Paving Program.



## 2024 ROADWAY INSPECTION REPORT TOWN OF RIVER BEND, NORTH CAROLINA

**ROAD NAME**                      TEAKWOOD DRIVE

	THOROUGHFARE <input type="checkbox"/>
<b>TRAFFIC LOADING</b>	COLLECTOR <input checked="" type="checkbox"/>
	LOCAL <input type="checkbox"/>

**PRIORITY NUMBER**

**APPROXIMATE LENGTH**    1,060 LF

**AVERAGE WIDTH**            18 LF

**TOTAL PAVEMENT AREA (SQUARE YARDS)**    2,438 SY

**PAVEMENT MARKINGS**   

**PAVEMENT SECTION**        DITCH

### VISUAL INSPECTION SUMMARY

TYPE OF DISTRESS	SEVERITY			
	NONE	LIGHT	MODERATE	SEVERE
ALLIGATOR CRACKING	<input type="checkbox"/>	<input checked="" type="checkbox"/>	<input type="checkbox"/>	<input type="checkbox"/>
BLOCK/TRANSVERSE CRACKING	<input type="checkbox"/>	<input checked="" type="checkbox"/>	<input type="checkbox"/>	<input type="checkbox"/>
RUTTING	<input checked="" type="checkbox"/>	<input type="checkbox"/>	<input type="checkbox"/>	<input type="checkbox"/>
RAVELING	<input checked="" type="checkbox"/>	<input type="checkbox"/>	<input type="checkbox"/>	<input type="checkbox"/>
BLEEDING	<input checked="" type="checkbox"/>	<input type="checkbox"/>	<input type="checkbox"/>	<input type="checkbox"/>
EXISTING PATCHING	<input type="checkbox"/>	<input checked="" type="checkbox"/>	<input type="checkbox"/>	<input type="checkbox"/>
OVERALL RIDE QUALITY	GOOD <input checked="" type="checkbox"/>	FAIR <input type="checkbox"/>	POOR <input type="checkbox"/>	
OVERALL ROAD CONDITION	GOOD <input checked="" type="checkbox"/>	FAIR <input type="checkbox"/>	POOR <input type="checkbox"/>	

**COMMENTS:**

This road segment was resurfaced as a part of the 2006 Paving Program.

# 2024 ROADWAY INSPECTION REPORT

## TOWN OF RIVER BEND, NORTH CAROLINA

**ROAD NAME** VIRGINIA COURT EXTENSION

**TRAFFIC LOADING** THOROUGHFARE   
 COLLECTOR   
 LOCAL

**PRIORITY NUMBER**

**APPROXIMATE LENGTH** LF

**AVERAGE WIDTH** LF

**TOTAL PAVEMENT AREA (SQUARE YARDS)** SY

**PAVEMENT MARKINGS**

**PAVEMENT SECTION** DITCH

### VISUAL INSPECTION SUMMARY

TYPE OF DISTRESS	SEVERITY			
	NONE	LIGHT	MODERATE	SEVERE
ALLIGATOR CRACKING	<input type="checkbox"/>	<input checked="" type="checkbox"/>	<input type="checkbox"/>	<input type="checkbox"/>
BLOCK/TRANSVERSE CRACKING	<input type="checkbox"/>	<input checked="" type="checkbox"/>	<input type="checkbox"/>	<input type="checkbox"/>
RUTTING	<input checked="" type="checkbox"/>	<input type="checkbox"/>	<input type="checkbox"/>	<input type="checkbox"/>
RAVELING	<input checked="" type="checkbox"/>	<input type="checkbox"/>	<input type="checkbox"/>	<input type="checkbox"/>
BLEEDING	<input checked="" type="checkbox"/>	<input type="checkbox"/>	<input type="checkbox"/>	<input type="checkbox"/>
EXISTING PATCHING	<input checked="" type="checkbox"/>	<input type="checkbox"/>	<input type="checkbox"/>	<input type="checkbox"/>
OVERALL RIDE QUALITY	GOOD <input checked="" type="checkbox"/>	FAIR <input type="checkbox"/>	POOR <input type="checkbox"/>	
OVERALL ROAD CONDITION	GOOD <input checked="" type="checkbox"/>	FAIR <input type="checkbox"/>	POOR <input type="checkbox"/>	

**COMMENTS:**

Road constructed in approximately 2018.



## 2024 ROADWAY INSPECTION REPORT TOWN OF RIVER BEND, NORTH CAROLINA

**ROAD NAME** VIRGINIA COURT

**TRAFFIC LOADING**  
 THOROUGHFARE   
 COLLECTOR   
 LOCAL

**PRIORITY NUMBER**

**APPROXIMATE LENGTH** 425 LF

**AVERAGE WIDTH** 18 LF

**TOTAL PAVEMENT AREA (SQUARE YARDS)** 980 SY

**PAVEMENT MARKINGS**

**PAVEMENT SECTION** DITCH

### VISUAL INSPECTION SUMMARY

TYPE OF DISTRESS	SEVERITY			
	NONE	LIGHT	MODERATE	SEVERE
ALLIGATOR CRACKING	<input type="checkbox"/>	<input type="checkbox"/>	<input checked="" type="checkbox"/>	<input type="checkbox"/>
BLOCK/TRANSVERSE CRACKING	<input type="checkbox"/>	<input type="checkbox"/>	<input checked="" type="checkbox"/>	<input type="checkbox"/>
RUTTING	<input checked="" type="checkbox"/>	<input type="checkbox"/>	<input type="checkbox"/>	<input type="checkbox"/>
RAVELING	<input checked="" type="checkbox"/>	<input type="checkbox"/>	<input type="checkbox"/>	<input type="checkbox"/>
BLEEDING	<input checked="" type="checkbox"/>	<input type="checkbox"/>	<input type="checkbox"/>	<input type="checkbox"/>
EXISTING PATCHING	<input checked="" type="checkbox"/>	<input type="checkbox"/>	<input type="checkbox"/>	<input type="checkbox"/>
OVERALL RIDE QUALITY	GOOD <input checked="" type="checkbox"/>	FAIR <input type="checkbox"/>	POOR <input type="checkbox"/>	
OVERALL ROAD CONDITION	GOOD <input type="checkbox"/>	FAIR <input checked="" type="checkbox"/>	POOR <input type="checkbox"/>	

**COMMENTS:**

This roadway segment has not been resurfaced. Roadway construction appears to be original.

NOTE: Eastern half of road was constructed in approximately 2018.

## 2024 ROADWAY INSPECTION REPORT TOWN OF RIVER BEND, NORTH CAROLINA

**ROAD NAME**                      WAKEFIELD DRIVE

	THOROUGHFARE <input type="checkbox"/>
<b>TRAFFIC LOADING</b>	COLLECTOR <input type="checkbox"/>
	LOCAL <input checked="" type="checkbox"/>

**PRIORITY NUMBER**

**APPROXIMATE LENGTH**    581 LF

**AVERAGE WIDTH**            18 LF

**TOTAL PAVEMENT AREA (SQUARE YARDS)**    1,336 SY

**PAVEMENT MARKINGS**   

**PAVEMENT SECTION**        DITCH

### VISUAL INSPECTION SUMMARY

TYPE OF DISTRESS	SEVERITY			
	NONE	LIGHT	MODERATE	SEVERE
ALLIGATOR CRACKING	<input type="checkbox"/>	<input type="checkbox"/>	<input type="checkbox"/>	<input checked="" type="checkbox"/>
BLOCK/TRANSVERSE CRACKING	<input type="checkbox"/>	<input type="checkbox"/>	<input checked="" type="checkbox"/>	<input type="checkbox"/>
RUTTING	<input checked="" type="checkbox"/>	<input type="checkbox"/>	<input type="checkbox"/>	<input type="checkbox"/>
RAVELING	<input checked="" type="checkbox"/>	<input type="checkbox"/>	<input type="checkbox"/>	<input type="checkbox"/>
BLEEDING	<input checked="" type="checkbox"/>	<input type="checkbox"/>	<input type="checkbox"/>	<input type="checkbox"/>
EXISTING PATCHING	<input type="checkbox"/>	<input checked="" type="checkbox"/>	<input type="checkbox"/>	<input type="checkbox"/>
 OVERALL RIDE QUALITY	GOOD <input type="checkbox"/>	FAIR <input checked="" type="checkbox"/>	POOR <input type="checkbox"/>	
OVERALL ROAD CONDITION	GOOD <input type="checkbox"/>	FAIR <input type="checkbox"/>	POOR <input checked="" type="checkbox"/>	

**COMMENTS:**

This roadway segment has not been resurfaced. Roadway construction appears to be original.

## 2024 ROADWAY INSPECTION REPORT TOWN OF RIVER BEND, NORTH CAROLINA

**ROAD NAME** WESTCHESTER

**TRAFFIC LOADING**  
 THOROUGHFARE   
 COLLECTOR   
 LOCAL

**PRIORITY NUMBER**

**APPROXIMATE LENGTH** 575 LF

**AVERAGE WIDTH** 18 LF

**TOTAL PAVEMENT AREA (SQUARE YARDS)** 1,322 SY

**PAVEMENT MARKINGS**

**PAVEMENT SECTION** SHOULDER

### VISUAL INSPECTION SUMMARY

TYPE OF DISTRESS	SEVERITY			
	NONE	LIGHT	MODERATE	SEVERE
ALLIGATOR CRACKING	<input type="checkbox"/>	<input checked="" type="checkbox"/>	<input type="checkbox"/>	<input type="checkbox"/>
BLOCK/TRANSVERSE CRACKING	<input checked="" type="checkbox"/>	<input type="checkbox"/>	<input type="checkbox"/>	<input type="checkbox"/>
RUTTING	<input checked="" type="checkbox"/>	<input type="checkbox"/>	<input type="checkbox"/>	<input type="checkbox"/>
RAVELING	<input checked="" type="checkbox"/>	<input type="checkbox"/>	<input type="checkbox"/>	<input type="checkbox"/>
BLEEDING	<input checked="" type="checkbox"/>	<input type="checkbox"/>	<input type="checkbox"/>	<input type="checkbox"/>
EXISTING PATCHING	<input checked="" type="checkbox"/>	<input type="checkbox"/>	<input type="checkbox"/>	<input type="checkbox"/>
OVERALL RIDE QUALITY	GOOD <input checked="" type="checkbox"/>	FAIR <input type="checkbox"/>	POOR <input type="checkbox"/>	
OVERALL ROAD CONDITION	GOOD <input checked="" type="checkbox"/>	FAIR <input type="checkbox"/>	POOR <input type="checkbox"/>	

**COMMENTS:**

This road segment was resurfaced as a part of the 2018 Paving Program.

# 2024 ROADWAY INSPECTION REPORT

## TOWN OF RIVER BEND, NORTH CAROLINA

**ROAD NAME**                      WILDWOOD DRIVE

**TRAFFIC LOADING**

THOROUGHFARE	<input type="checkbox"/>
COLLECTOR	<input checked="" type="checkbox"/>
LOCAL	<input type="checkbox"/>

**PRIORITY NUMBER**

**APPROXIMATE LENGTH**    2,270 LF                                      **AVERAGE WIDTH**                      20 LF

**TOTAL PAVEMENT AREA (SQUARE YARDS)**    5,801 SY

**PAVEMENT MARKINGS**                                          **PAVEMENT SECTION**                      DITCH

### VISUAL INSPECTION SUMMARY

TYPE OF DISTRESS	SEVERITY			
	NONE	LIGHT	MODERATE	SEVERE
ALLIGATOR CRACKING	■	<input type="checkbox"/>	<input type="checkbox"/>	<input type="checkbox"/>
BLOCK/TRANSVERSE CRACKING	■	<input type="checkbox"/>	<input type="checkbox"/>	<input type="checkbox"/>
RUTTING	■	<input type="checkbox"/>	<input type="checkbox"/>	<input type="checkbox"/>
RAVELING	■	<input type="checkbox"/>	<input type="checkbox"/>	<input type="checkbox"/>
BLEEDING	■	<input type="checkbox"/>	<input type="checkbox"/>	<input type="checkbox"/>
EXISTING PATCHING	<input type="checkbox"/>	■	<input type="checkbox"/>	<input type="checkbox"/>
OVERALL RIDE QUALITY	GOOD ■	FAIR <input type="checkbox"/>	POOR <input type="checkbox"/>	
OVERALL ROAD CONDITION	GOOD ■	FAIR <input type="checkbox"/>	POOR <input type="checkbox"/>	

**COMMENTS:**

This road segment was resurfaced as a part of the 2017 Paving Program.

# 2024 ROADWAY INSPECTION REPORT

## TOWN OF RIVER BEND, NORTH CAROLINA

**ROAD NAME**                      WILLOWBROOK

**TRAFFIC LOADING**

THOROUGHFARE	<input type="checkbox"/>
COLLECTOR	<input type="checkbox"/>
LOCAL	<input checked="" type="checkbox"/>

**PRIORITY NUMBER**

**APPROXIMATE LENGTH**    370 LF                                      **AVERAGE WIDTH**                      18 LF

**TOTAL PAVEMENT AREA (SQUARE YARDS)**    851 SY

**PAVEMENT MARKINGS**                                          **PAVEMENT SECTION**                      DITCH

### VISUAL INSPECTION SUMMARY

TYPE OF DISTRESS	SEVERITY			
	NONE	LIGHT	MODERATE	SEVERE
ALLIGATOR CRACKING	<input type="checkbox"/>	<input checked="" type="checkbox"/>	<input type="checkbox"/>	<input type="checkbox"/>
BLOCK/TRANSVERSE CRACKING	<input type="checkbox"/>	<input checked="" type="checkbox"/>	<input type="checkbox"/>	<input type="checkbox"/>
RUTTING	<input checked="" type="checkbox"/>	<input type="checkbox"/>	<input type="checkbox"/>	<input type="checkbox"/>
RAVELING	<input checked="" type="checkbox"/>	<input type="checkbox"/>	<input type="checkbox"/>	<input type="checkbox"/>
BLEEDING	<input checked="" type="checkbox"/>	<input type="checkbox"/>	<input type="checkbox"/>	<input type="checkbox"/>
EXISTING PATCHING	<input checked="" type="checkbox"/>	<input type="checkbox"/>	<input type="checkbox"/>	<input type="checkbox"/>
OVERALL RIDE QUALITY	GOOD <input checked="" type="checkbox"/>	FAIR <input type="checkbox"/>	POOR <input type="checkbox"/>	
OVERALL ROAD CONDITION	GOOD <input checked="" type="checkbox"/>	FAIR <input type="checkbox"/>	POOR <input type="checkbox"/>	

**COMMENTS:**

This road segment resurfaced as a part of the 2006 Paving Program.



Figure 1



**Municipal Certification**

There have been changes in our streets as to length. There have not been changes to system status, nor to the corporate limits, since July 16, 1999.  
Attest:

*John R. Kirkland* 7/1/20  
John R. Kirkland, Mayor Date

*Ann H. Katsuyoshi* 7/1/20  
Ann H. Katsuyoshi, Town Clerk Date

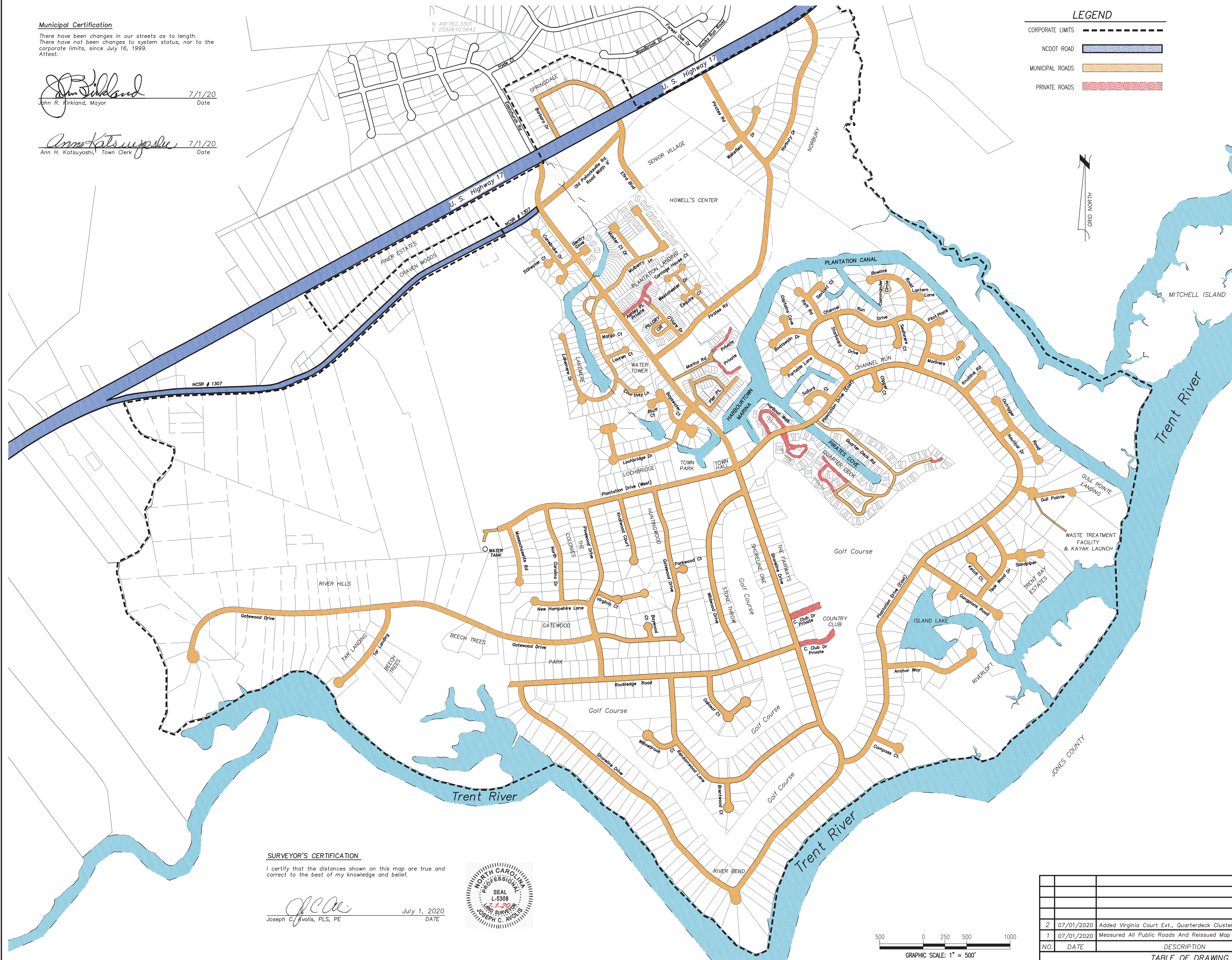

2020 Town of River Bend Powell Bill Street Listing	
Street Name	Length (mi)
Anchor Way	0.21
Barbara Drive	0.30
Bayswater Court	0.12
Baywood Court	0.03
Bluff Court	0.03
Boatswain Drive	0.09
Bowline Road	0.15
Canebrake Drive	0.17
Captains Cove	0.03
Carriage House Court	0.05
Channel Run Drive	0.53
Clipper Court	0.04
Commander Circle	0.03
Compass Court	0.06
Courtney Lane	0.07
Efird Boulevard	0.17
Esquire Court	0.05
Gangplank Road	0.27
Gatewood Drive	1.48
Gentry Cove	0.03
Gull Pointe Extension	0.11
Gull Pointe	0.12
Harbour Walk	0.00
Ketch Court	0.06
Knollwood Court	0.14
Knotline Road	0.05
Lakemere Drive	0.51
Lantern Lane	0.02
Lauren Court	0.05
Lochbridge Drive	0.29
Margo Court	0.03
Marina Road	0.12
Mariners Court	0.09
Massachusetts Road	0.12
Master Court Drive	0.09
Mulberry Lane	0.27
Nautical Drive	0.04
New Hampshire Lane	0.12
Norbury Drive	0.36
North Carolina Drive	0.22
O'Hara Drive	0.12
Oakleaf Court	0.15
Old Pollockville Road	0.25
Outrigger Road	0.16
Parkwood Court	0.02
Pier Pointe Streets	0.27
Pillory Circle	0.08
Pilot Place	0.03
Pinewood Drive	0.39
Pirates Road	0.78
Plantation Drive East	1.62
Plantation Drive West	0.58
Portside Lane	0.07
Quardeck Road Cluster III	0.17
Quardeck Road I/II	0.34
Raft Road	0.08
Randomwood Lane	0.54
Rockledge Road	0.63
Sailors Court	0.06
Sandpiper Court	0.08
Seafarers Court	0.05
Sextant Court	0.04
Shoreline Drive	2.54
Starboard Drive	0.11
Stillwater Court	0.02
Tar Landing	0.21
Teakwood Drive	0.20
Virginia Court	0.05
Virginia Court Extension	0.06
Wakefield Drive	0.10
Westchester Drive	0.11
Wildwood Road	0.00
Wildwood Drive	0.42
Willowbrook Court	0.07
<b>Mileage Total</b>	<b>17.13</b>

Legend: Edits This Year -

**SURVEYOR'S CERTIFICATION**  
I certify that the distances shown on this map are true and correct to the best of my knowledge and belief.

*Joseph C. Avolis* July 1, 2020  
Joseph C. Avolis, PLS, PE DATE



NO.	DATE	DESCRIPTION	BY
2	07/01/2020	Added Virginia Court Ext., Quardeck Cluster III, Gull Pointe Ext.	JCA
1	07/01/2020	Measured All Public Roads And Reissued Map	JCA

TABLE OF DRAWING REVISIONS

PROJECT NO. 20027  
SCALE: AS NOTED  
DRAWN BY: MSP  
CHECKED BY: JKA  
DATE: 6/4/20

LICENSE NO. C-0706

AVOLIS ENGINEERING, P.A.  
P.O. BOX 15564  
NEW BERN, NC 28561  
PH: (252) 633-0068

2020 POWELL BILL MAP  
TOWN OF RIVER BEND  
CRAVEN COUNTY, NORTH CAROLINA  
COVER SHEET

**PB**  
20027



Figure 2



1	Update to include PY17-22	JCA	10-25-22
2	Update to include PY23-24	JKA	7-22-24
NO.	DESCRIPTION	BY	DATE
Revisions			



Legend	
[Red Line]	Program Year 2000
[Yellow Line]	Program Year 2002
[Green Line]	Program Year 2003
[Cyan Line]	Program Year 2004
[Blue Line]	Program Year 2005
[Magenta Line]	Program Year 2006
[Black Line]	Program Year 2007
[Olive Line]	Program Year 2008
[Grey Line]	Program Year 2009
[Dark Green Line]	Program Year 2010
[Purple Line]	Program Year 2011
[Light Green Line]	Program Year 2012
[Brown Line]	Program Year 2013
[Dark Red Line]	Program Year 2014
[Dark Blue Line]	Program Year 2015
[Light Blue Line]	Program Year 2016
[Orange Line]	Program Year 2017
[Light Orange Line]	Program Year 2018
[Light Purple Line]	Program Year 2019
[Light Green Line]	Program Year 2020
[Light Yellow Line]	Program Year 2021
[Light Green Line]	Program Year 2022
[Light Yellow Line]	Program Year 2023
[Light Green Line]	Program Year 2024
[Black Line]	Corporate Limits
[Red Line]	Priority Ranking

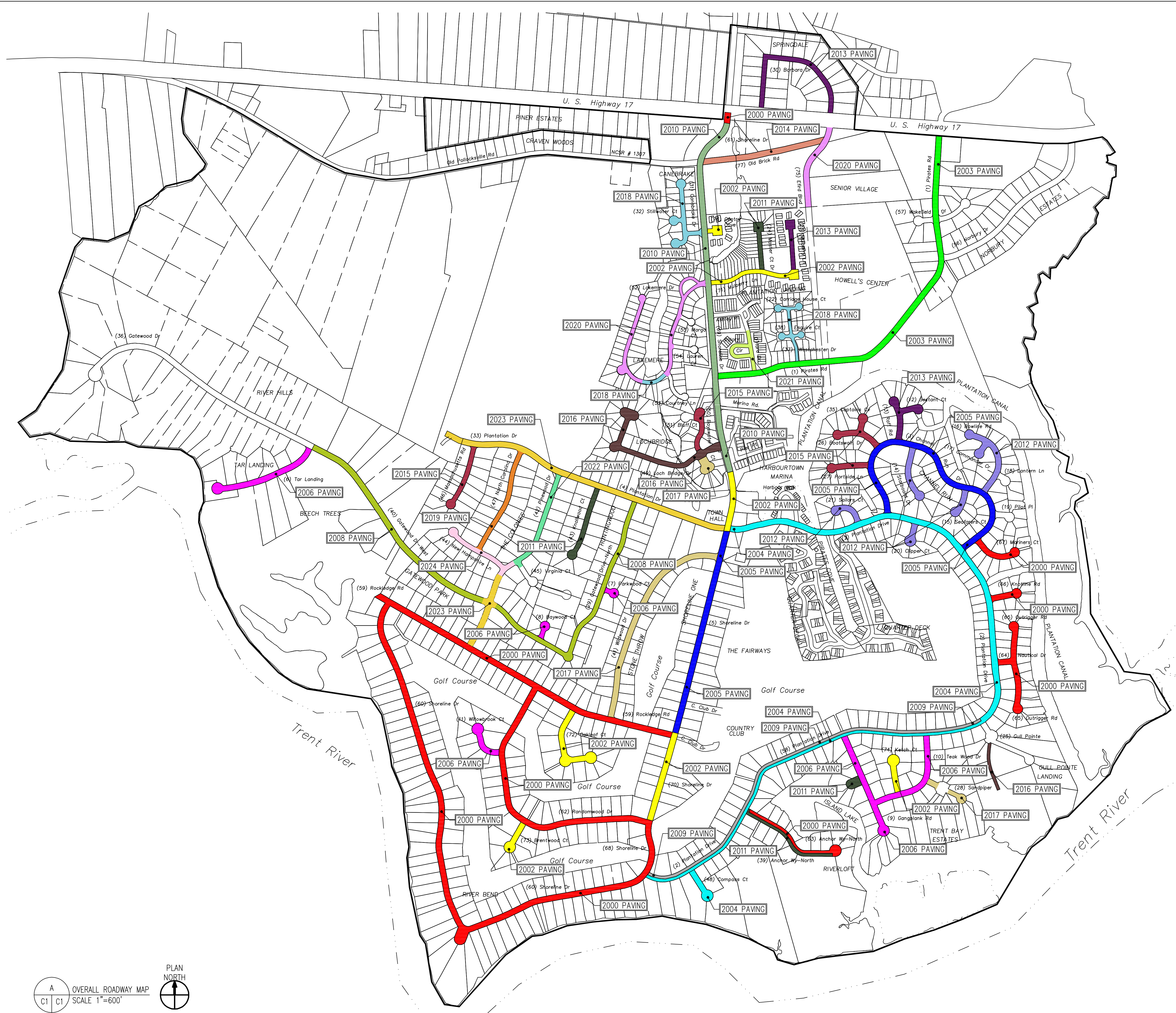

PROJECT NO. 24021  
 SCALE: AS NOTED  
 DRAWN BY: MSP  
 CHECKED BY: JKA  
 DATE:

LICENSE NO. C-0706

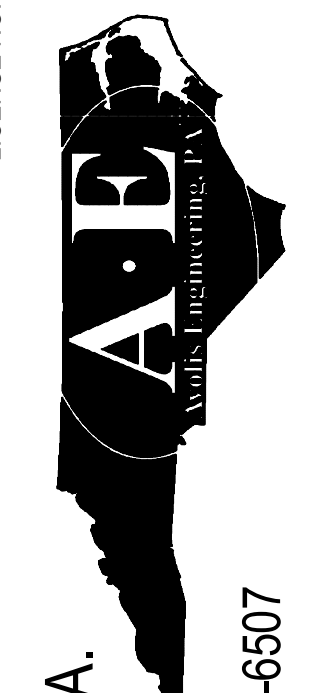

AVOLIS ENGINEERING, P.A.  
 P.O. BOX 15564  
 NEW BERN, NC 28561  
 PH: (252) 633-0068, FAX (252) 633-6507

PAVEMENT IMPROVEMENT PROGRAM  
 TOWN OF RIVER BEND  
 CRAVEN COUNTY, NORTH CAROLINA  
 OVERALL ROADWAY MAP

A  
 C1 C1  
 OVERALL ROADWAY MAP  
 SCALE 1"=600'



JULY 22, 2024  
 GRAPHIC SCALE: 1" = 600'

C1  
 24021